

**BY-LAW NO.**

**A By-law to amend  
Zoning and Development By-law No. 3575  
to rezone an area to CD-1**

THE COUNCIL OF THE CITY OF VANCOUVER, in public meeting, enacts as follows:

**Zoning District Plan Amendment**

1. This by-law amends the Zoning District Plan attached as Schedule D to By-law No. 3575, and amends or substitutes the boundaries and districts shown on it, according to the amendments, substitutions, explanatory legends, notations, and references shown on the plan attached as Schedule A to this by-law, and incorporates Schedule A into Schedule D of By-law No. 3575.

**Designation of CD-1 District**

2. The area shown within the heavy black outline on Schedule A is hereby designated CD-1 (\_\_\_).

**Sub-areas**

3. The site is to consist of 2 sub-areas generally as illustrated in Figure 1, solely for the purposes of establishing the maximum permitted building height for each sub-area.

**Figure 1: Sub-areas**

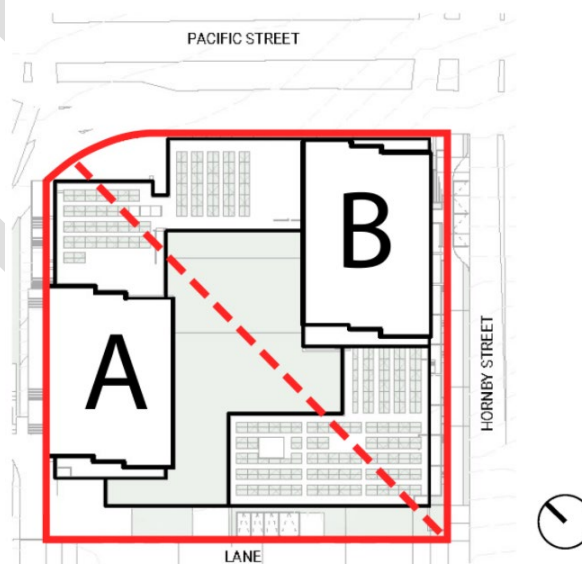

## Uses

4. Subject to approval of the form of development, to all conditions, guidelines and policies adopted by Council, and to the conditions set out in this By-law or in a development permit, the only uses permitted in this CD-1 and the only uses for which the Director of Planning or Development Permit Board will issue development permits are:

- (a) Cultural and Recreational Uses;
- (b) Dwelling Uses, limited to Mixed-Use Residential Building;
- (c) Institutional Uses;
- (d) Office Uses;
- (e) Retail Uses;
- (f) Service Uses;
- (g) Utility and Communication Uses; and
- (h) Accessory Uses customarily ancillary to the above use.

## Conditions of Use

5.1 The design and layout of at least 35% of the total number of dwelling units must:

- (a) be suitable for family housing; and
- (b) have 2 or more bedrooms.

5.2 All commercial uses and accessory uses must be carried on wholly within a completely enclosed building, other than the following:

- (a) display of flowers, plants, fruits and vegetables in combination with a permitted use;
- (b) farmers' market;
- (c) neighbourhood public house;
- (d) public bike share; and
- (e) restaurant,

except that the Director of Planning may vary this regulation to permit the outdoor display of retail goods, and the Director of Planning may impose any conditions the Director of Planning considers necessary, having regard to the types of merchandise, the area and location of the display with respect to adjoining sites, the hours of operation and the intent of this by-law.

## Floor Area and Density

- 6.1 The total floor area permitted for all uses must not exceed 80,700 m<sup>2</sup>.
- 6.2 The total floor area for commercial uses must be a minimum 1,200 m<sup>2</sup>.
- 6.3 Computation of floor area must include all floors having a minimum ceiling height of 1.2 m, both above and below base surface, measured to the extreme outer limits of the building.
- 6.4 Computation of floor area must exclude:
- (a) balconies and decks and any other appurtenances which, in the opinion of the Director of Planning, are similar to the foregoing, provided that:
    - (i) the total area of these exclusions must not exceed 12% of the permitted floor area, and
    - (ii) the balconies must not be enclosed for the life of the building;
  - (b) patios and roof decks, if the Director of Planning considers the impact on privacy and outlook;
  - (c) floors or portions thereof that are used for:
    - (i) off-street parking and loading located at or below base surface, provided that the maximum exclusion for a parking space does not exceed 7.3 m in length,
    - (ii) bicycle storage, and
    - (iii) heating and mechanical equipment, or uses that the Director of Planning considers similar to the foregoing;
  - (d) entries, porches and verandahs if the Director of Planning first approves the design;
  - (e) all residential storage area above or below base surface, except that if residential storage area above base surface exceeds 3.7 m<sup>2</sup> per dwelling unit, there will be no exclusion for any of the residential storage area above base surface for that unit; and
  - (f) all storage area below base surface for non-dwelling uses.
- 6.5 The Director of Planning or Development Permit Board may exclude:
- (a) common amenity areas from the computation of floor area, to a maximum of 10% of the total permitted floor area; and
  - (b) unenclosed outdoor areas underneath the building overhangs, except that such areas must remain unenclosed for the life of the building,

if the Director of Planning or Development Permit Board considers the intent of this by-law and all applicable Council policies and guidelines.

## **Building Height**

7.1 Building heights in each sub-area must not exceed the permitted height for that sub-area, as set out in Table 1.

**Table 1: Permitted Building Height**

<b>Sub-area</b>	<b>Building Height</b>
A	127 m
B	165 m

7.2 Despite section of this by-law and building height regulations in section 10 of the Zoning and Development By-law, the Director of Planning, after considering the impact on building placement, massing, views, overlook, shadowing and noise, may permit architectural features, common rooftop amenity space or mechanical appurtenances including elevator overrun and rooftop access structures, or any other appurtenances that the Director of Planning considers similar to the foregoing, to exceed the maximum building height.

## **Access to Natural Light**

8.1 Each habitable room must have at least 1 window on an exterior wall of a building.

8.2 For the purposes of section 8.1 above, habitable room means any room except a bathroom or a kitchen.

## **Severability**

9. A decision by a court that any part of this by-law is illegal, void, or unenforceable severs that part from this by-law, and is not to affect the balance of this by-law.

## **Force and Effect**

10. This by-law is to come into force and take effect on the date of its enactment.

ENACTED by Council this      day of      , 2026

\_\_\_\_\_  
Mayor

\_\_\_\_\_  
City Clerk

