

BY-LAW NO.

**A By-law to amend
Zoning and Development By-law No. 3575
to rezone areas from RS-1 and RT-1 to RM-8A and RM-8AN**

THE COUNCIL OF THE CITY OF VANCOUVER, in public meeting, enacts as follows:

1. This by-law amends the indicated provisions of the Zoning and Development By-law No. 3575.
2. This by-law amends the Zoning District Plan attached as Schedule D to By-law No. 3575, and amends or substitutes the boundaries and districts shown on it, according to the amendments, substitutions, explanatory legends, notations, and references shown on the plans attached as Schedules A, B, C and D to this by-law, and incorporates Schedules A, B, C and D into Schedule D of By-law No. 3575.
3. The areas shown within the heavy black outline on:
 - (a) Schedule A are rezoned and moved from the RS-1 district to the RM-8A district;
 - (b) Schedule B are rezoned and moved from the RT-1 district to the RM-8A district;
 - (c) Schedule C are rezoned and moved from the RS-1 district to the RM-8AN district; and
 - (d) Schedule D are rezoned and moved from the RT-1 district to the RM-8AN district.
4. This by-law is to come into force and take effect on the date of its enactment.

ENACTED by Council this day of , 2023

Mayor

City Clerk

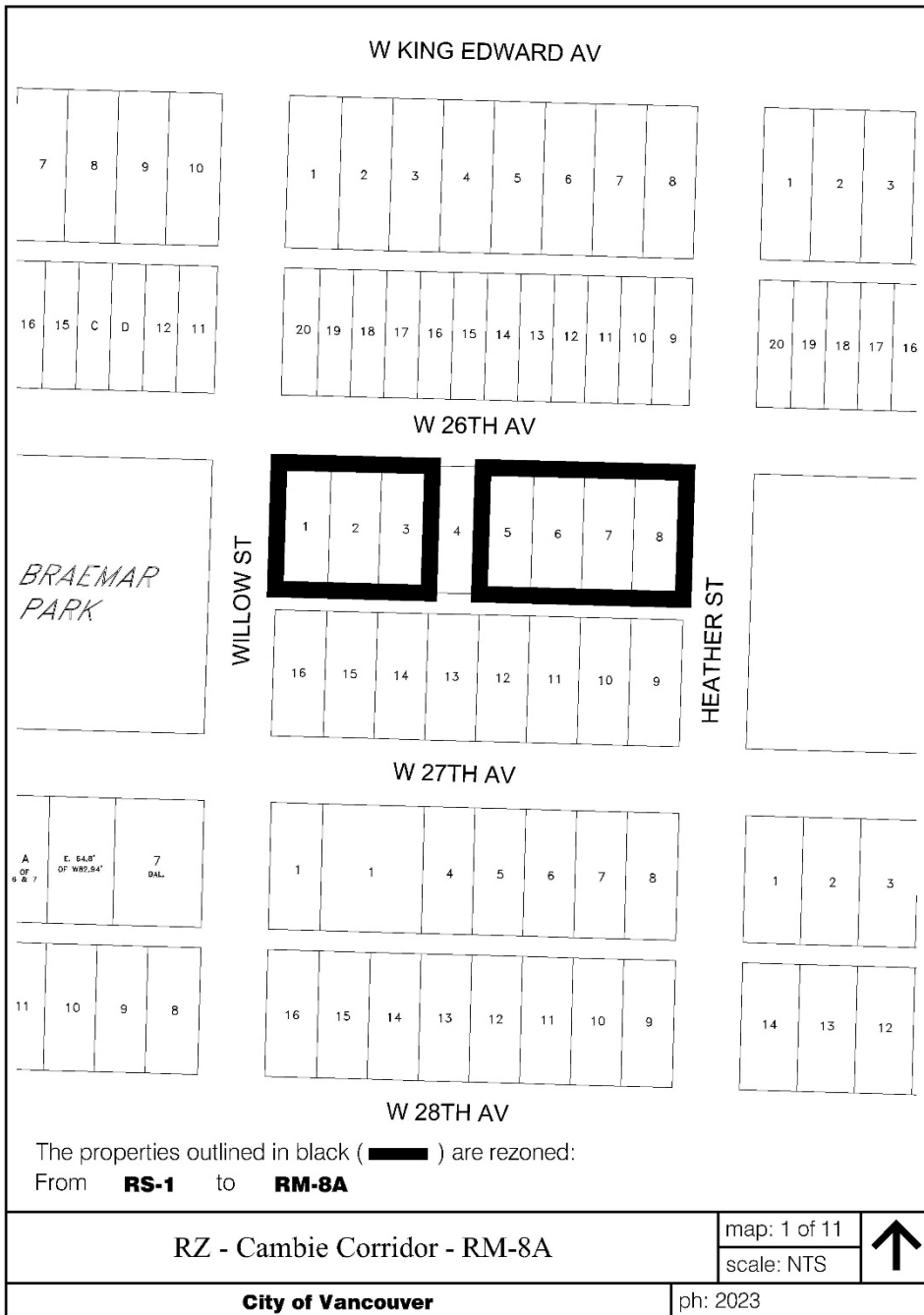

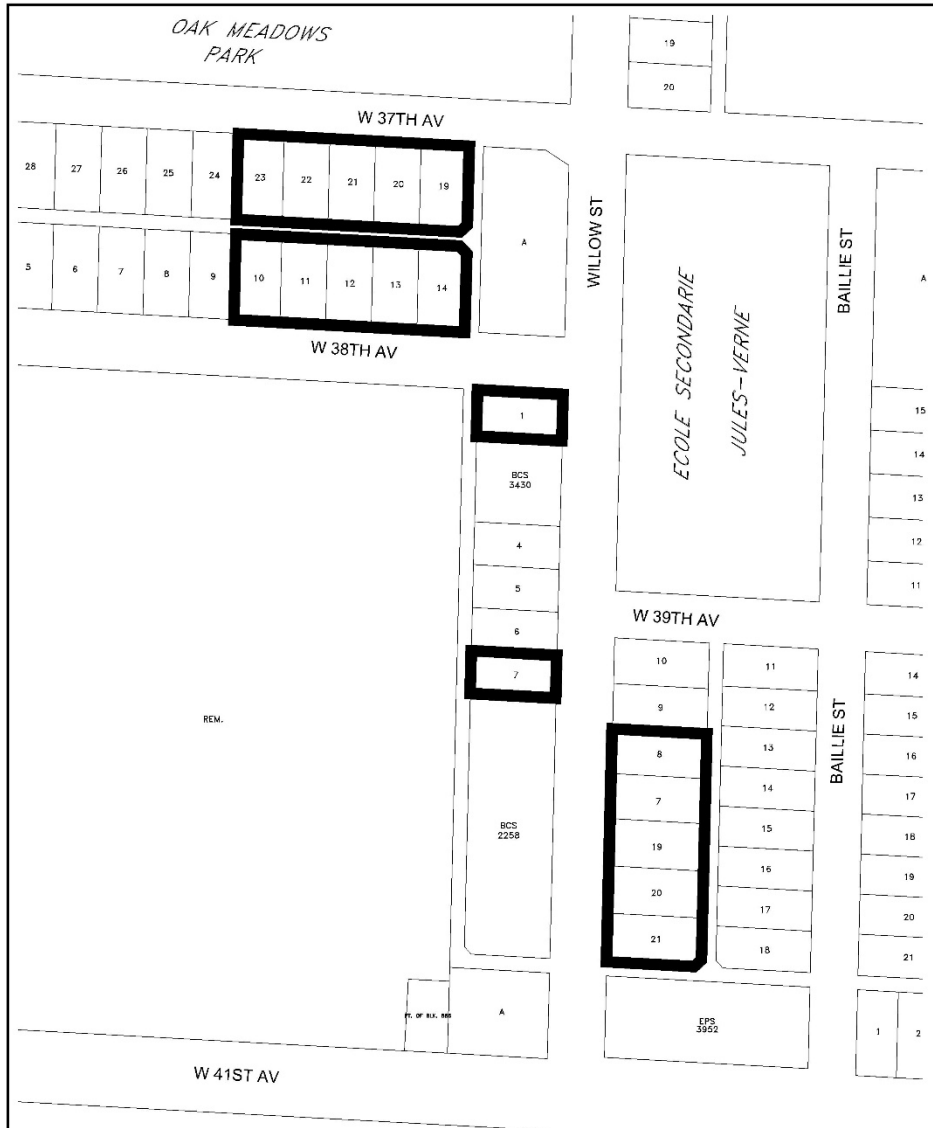

The properties outlined in black (**█**) are rezoned:
 From **RS-1** to **RM-8A**

RZ - Cambie Corridor - RM-8A

map: 2 of 11
 scale: NTS



City of Vancouver

ph: 2023

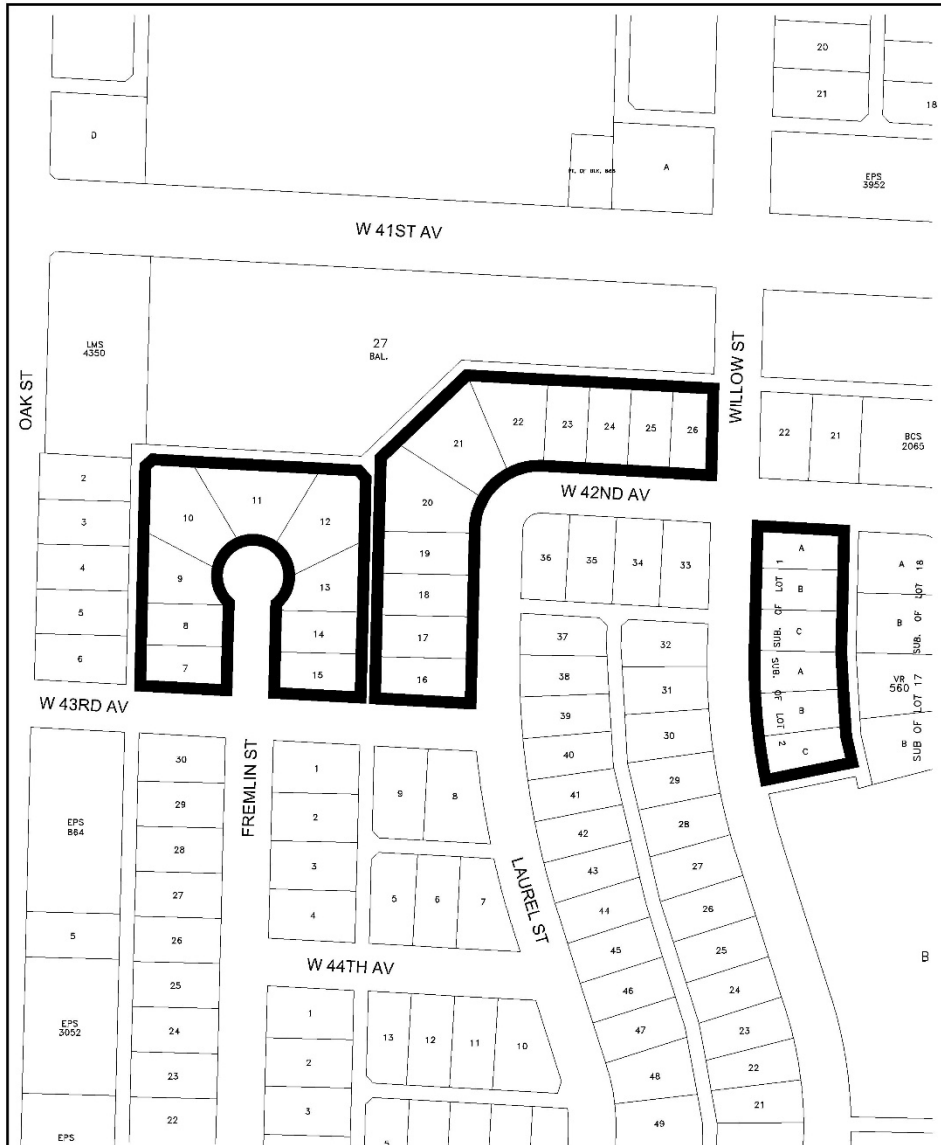

The properties outlined in black () are rezoned:
From **RS-1** to **RM-8A**

RZ - Cambie Corridor - RM-8A

map: 3 of 11

scale: NTS



City of Vancouver

ph: 2023

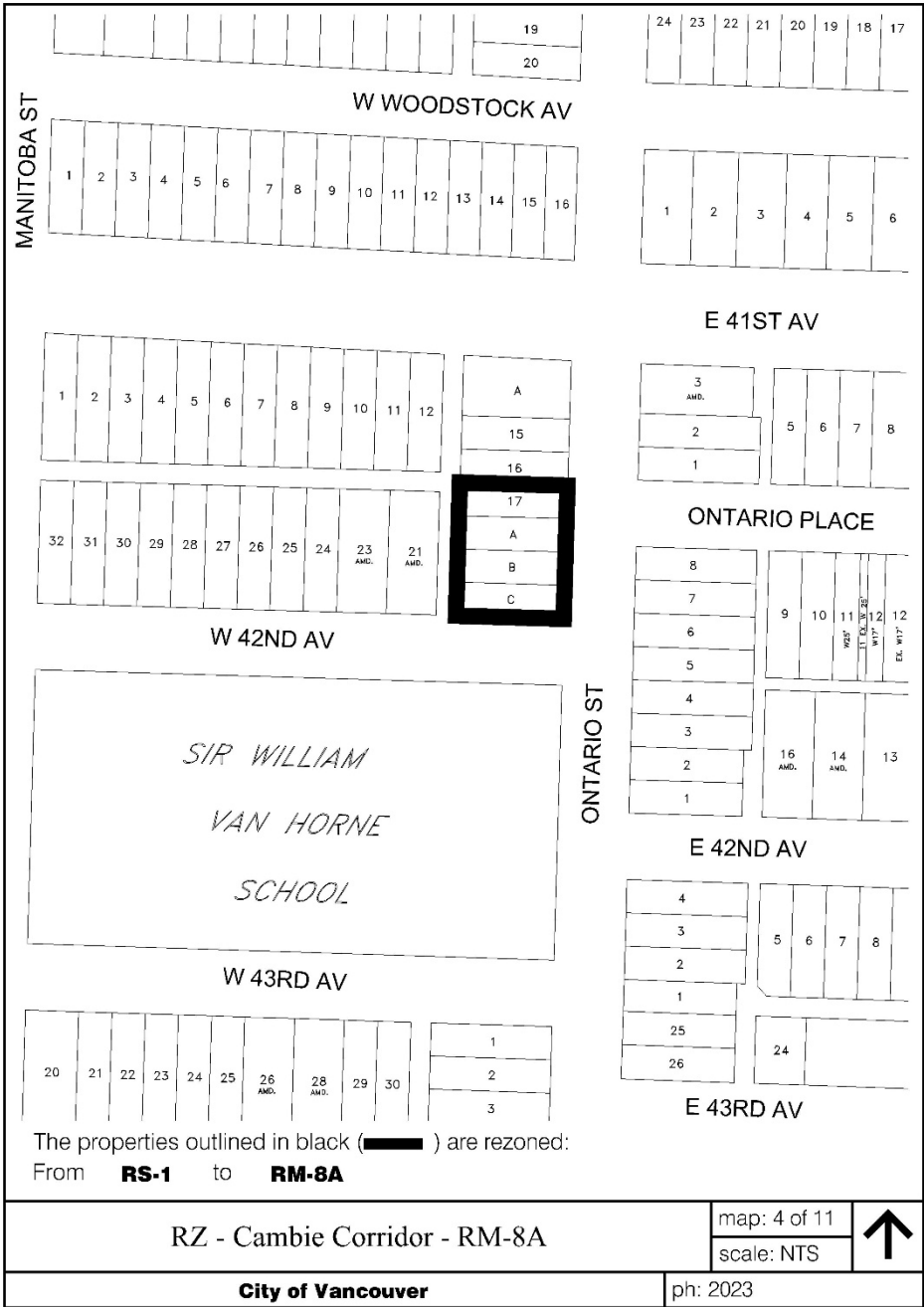

The properties outlined in black () are rezoned:
From **RS-1** to **RM-8A**

RZ - Cambie Corridor - RM-8A

map: 4 of 11
scale: NTS



City of Vancouver

ph: 2023



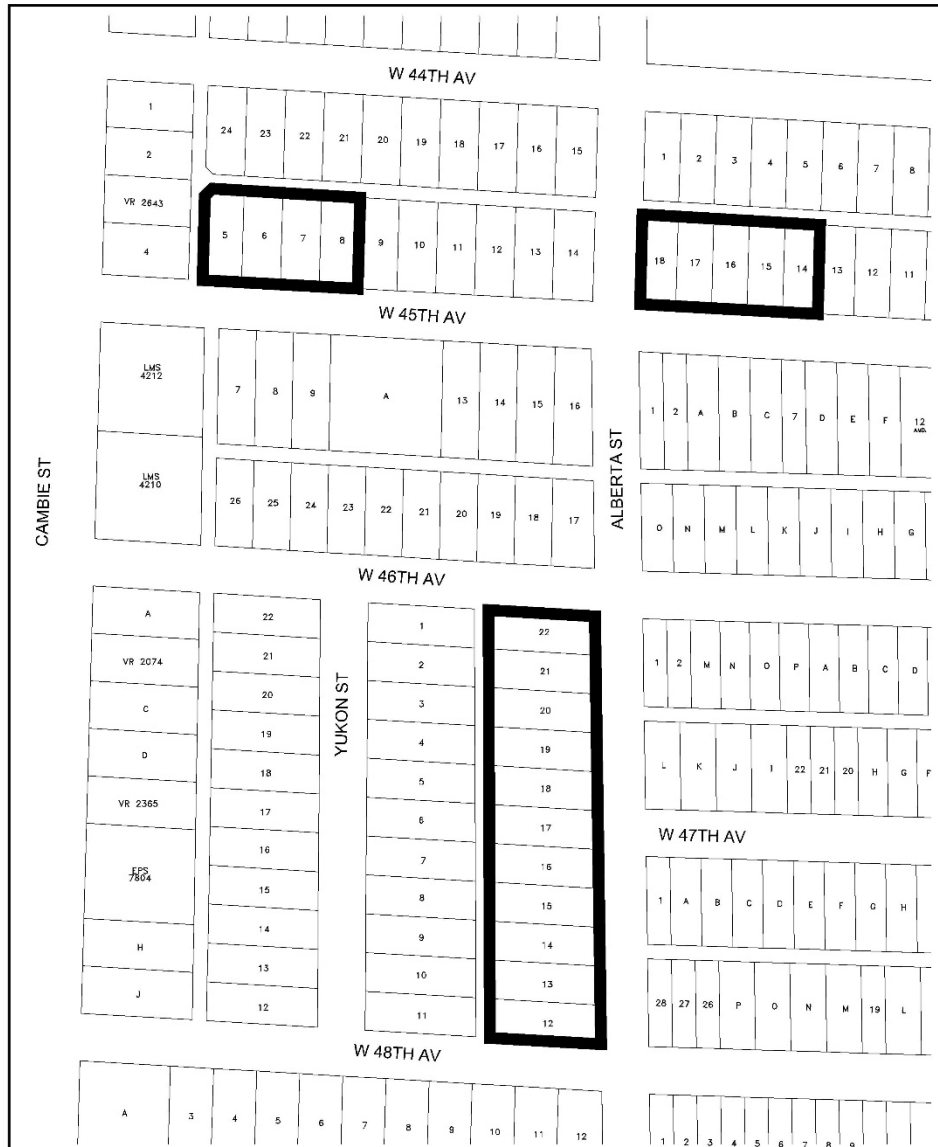

The properties outlined in black (**█**) are rezoned:
 From **RS-1** to **RM-8A**

RZ - Cambie Corridor - RM-8A

map: 6 of 11

scale: NTS



City of Vancouver

ph: 2023

Schedule A

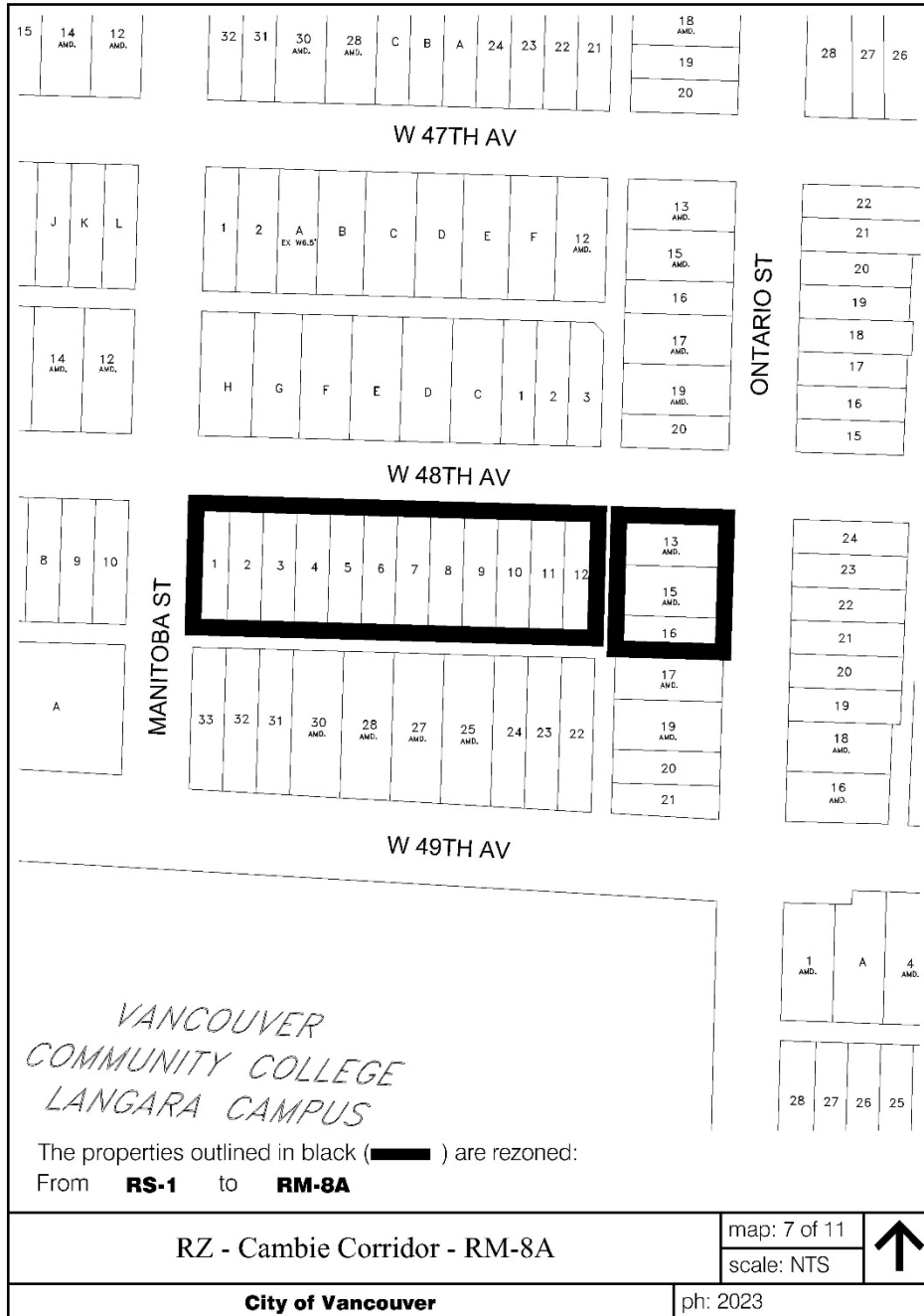

Schedule A

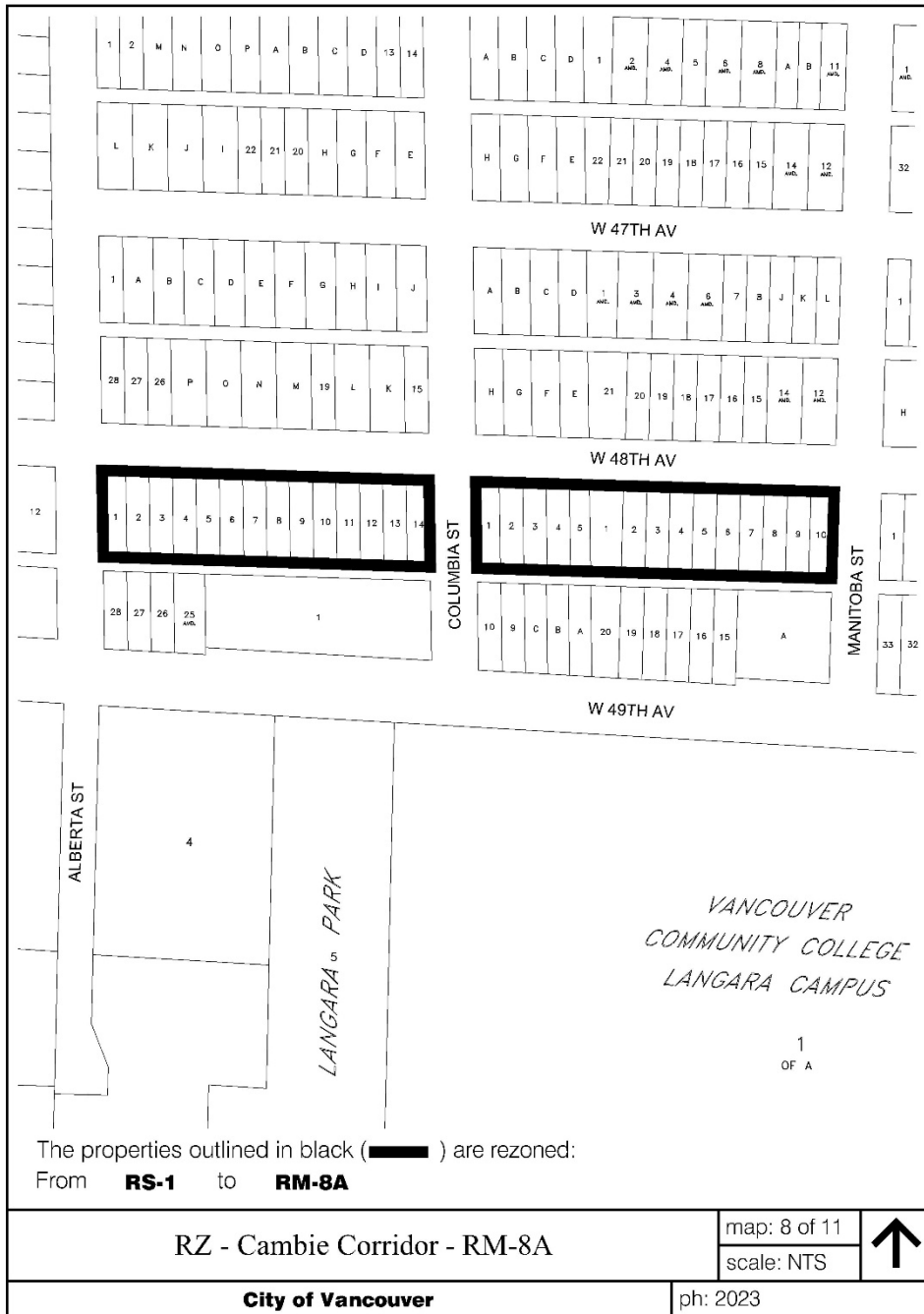

The properties outlined in black () are rezoned:
 From **RS-1** to **RM-8A**

RZ - Cambie Corridor - RM-8A

map: 8 of 11

scale: NTS



City of Vancouver

ph: 2023

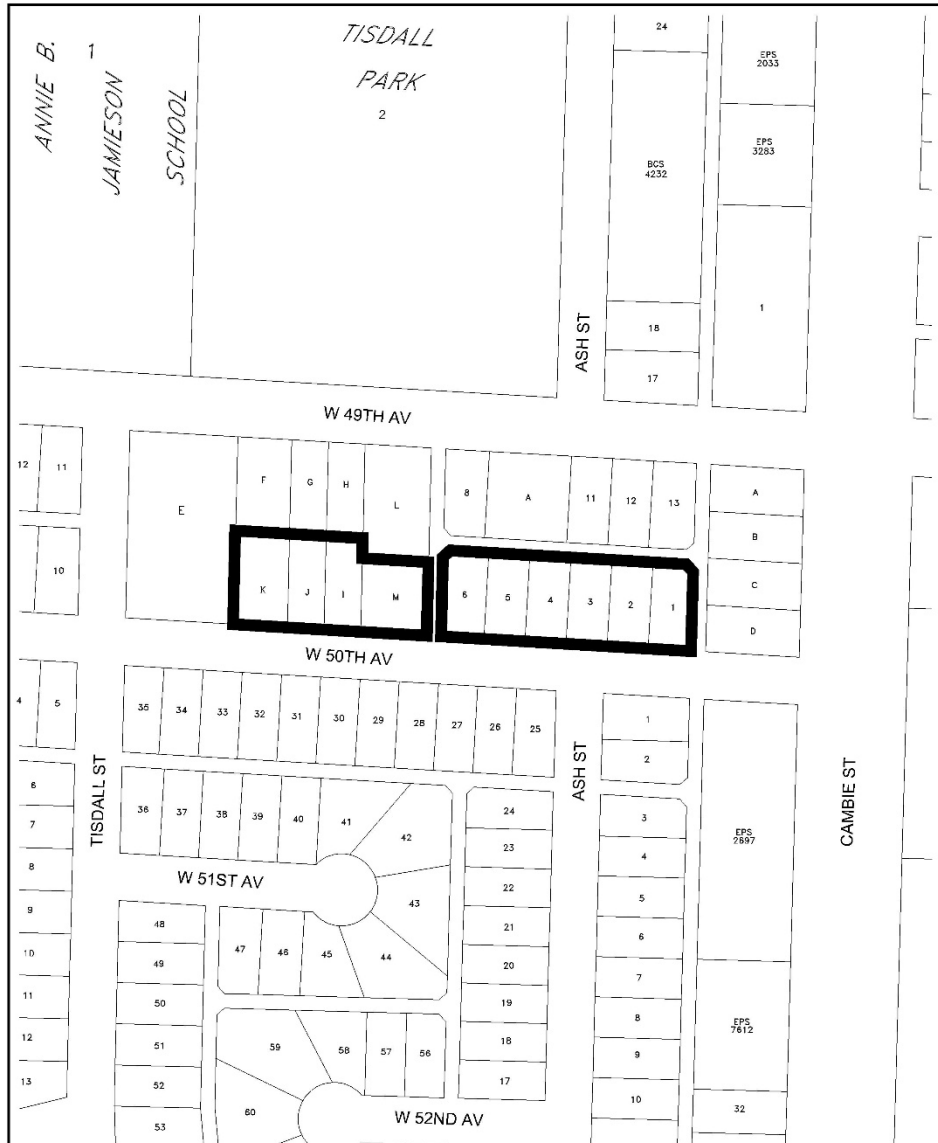

The properties outlined in black () are rezoned:
 From **RS-1** to **RM-8A**

RZ - Cambie Corridor - RM-8A

map: 9 of 11
 scale: NTS



City of Vancouver

ph: 2023

Schedule A



The properties outlined in black () are rezoned:
From **RS-1** to **RM-8A**

RZ - Cambie Corridor - RM-8A

map:10 of 11

scale: NTS



City of Vancouver

ph: 2023



The properties outlined in black () are rezoned:
 From **RS-1** to **RM-8A**

RZ - Cambie Corridor - RM-8A

map: 11 of 11
 scale: NTS



City of Vancouver

ph: 2023

Schedule B

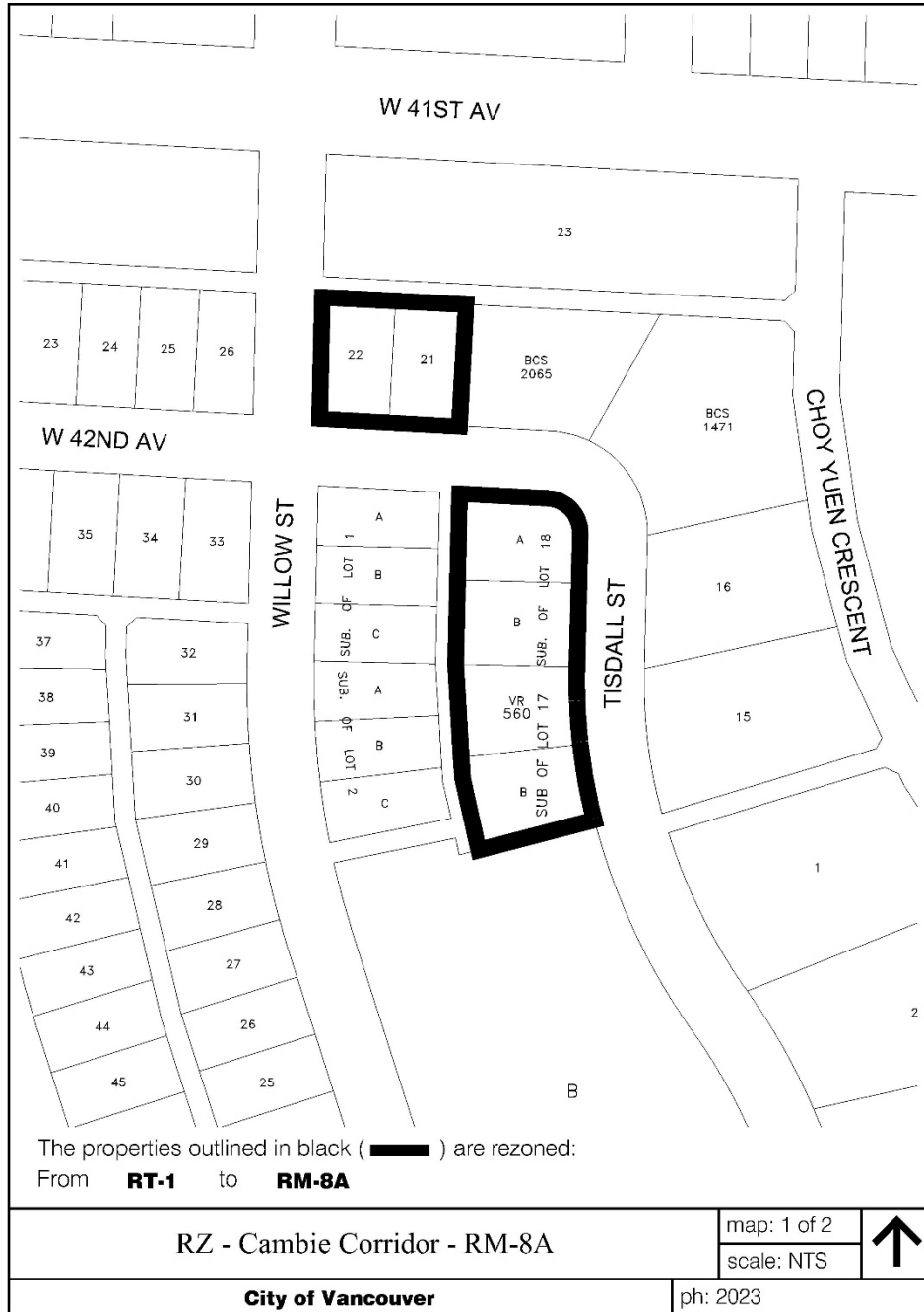

Schedule B

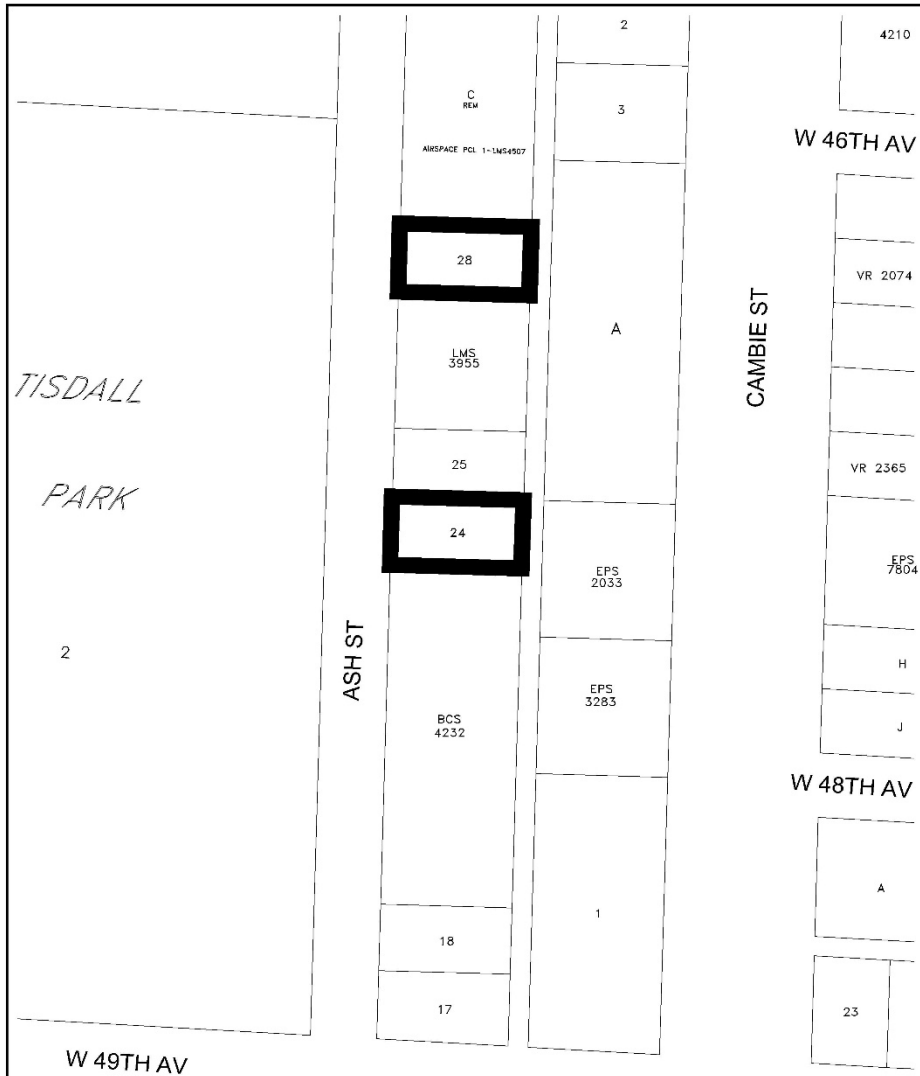

The properties outlined in black (█) are rezoned:
 From **RT-1** to **RM-8A**

RZ - Cambie Corridor - RM-8A	map: 2 of 2	
	scale: NTS	
City of Vancouver	ph: 2023	

Schedule C



Schedule C



ANNIE B.
JAMIESON
SCHOOL

The properties outlined in black () are rezoned:
From **RS-1** to **RM-8AN**

RZ - Cambie Corridor - RM-8AN

map: 2 of 3
scale: NTS



City of Vancouver

ph: 2023

Schedule C

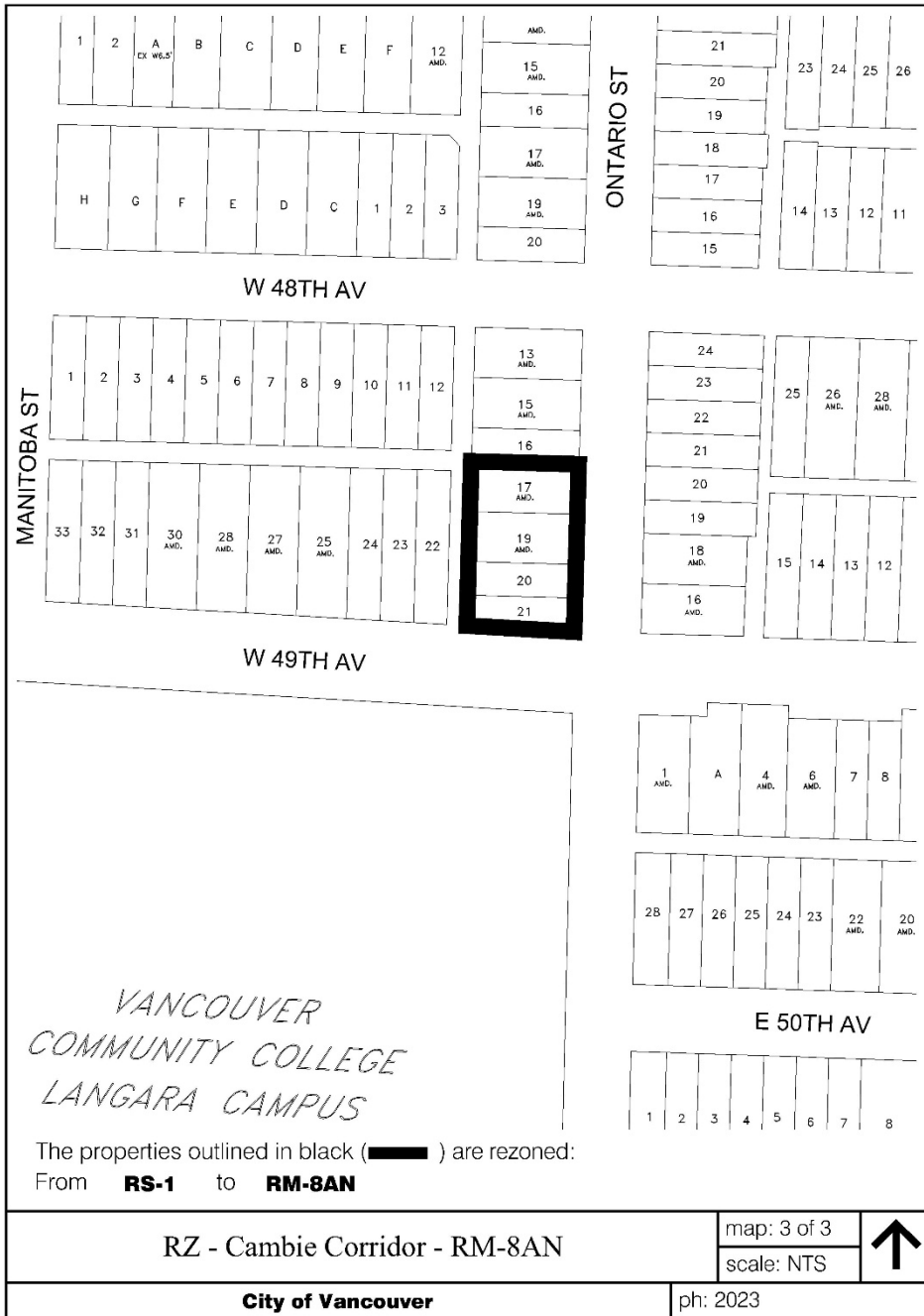

The properties outlined in black () are rezoned:
From **RS-1** to **RM-8AN**

RZ - Cambie Corridor - RM-8AN

map: 3 of 3
scale: NTS



City of Vancouver

ph: 2023

Schedule D

