

**BY-LAW NO.**

**A By-law to amend the Zoning and Development By-law  
Regarding the rezoning of RT-7 and RT-8 to RT-5,  
and RT-10 and RT-10N to RT-11 and RT-11N**

1. This By-law amends the indicated provisions of the Zoning and Development By-law No. 3575.
2. This by-law amends the Zoning District Plan attached as Schedule D to By-law No. 3575, and amends or substitutes the boundaries and districts shown on it, according to the amendments, substitutions, explanatory legends, notations, and references shown on the plans marginally numbered Z-745 (c) (i), Z-745 (c) (ii), Z-745 (c) (iii), and Z-745 (c) (iv) attached as Schedule A to this by-law, and incorporates Schedule A into Schedule D of By-law No. 3575.
3. Council repeals the RT-7, RT-8, and RT-10 and RT-10N District Schedules.
4. In section 3.2.7, Council:
  - (a) strikes out the words “RT-7, RT-8,”; and
  - (b) strikes out the words “RT-10 and RT-10N,”.
5. In section 3.2.10(c), Council:
  - (a) strikes out the words “RT-7,”; and
  - (b) strikes out the words “RT-10”.
6. Under Column 2 of item 2 in section 5.14, Council:
  - (a) strikes out the words “RT-7, RT-8,”; and
  - (b) strikes out the words “RT-10 and RT-10N,”.
7. Under Two-Family Dwelling in section 9.1, Council:
  - (a) strikes out the words “RT-7”;
  - (b) strikes out the words “RT-8”; and
  - (c) strikes out the words “RT-10 and RT-10N”.
8. A decision by a court that any part of this By-law is illegal, void, or unenforceable severs that part from this By-law, and is not to affect the balance of this By-law.



**Schedule A**

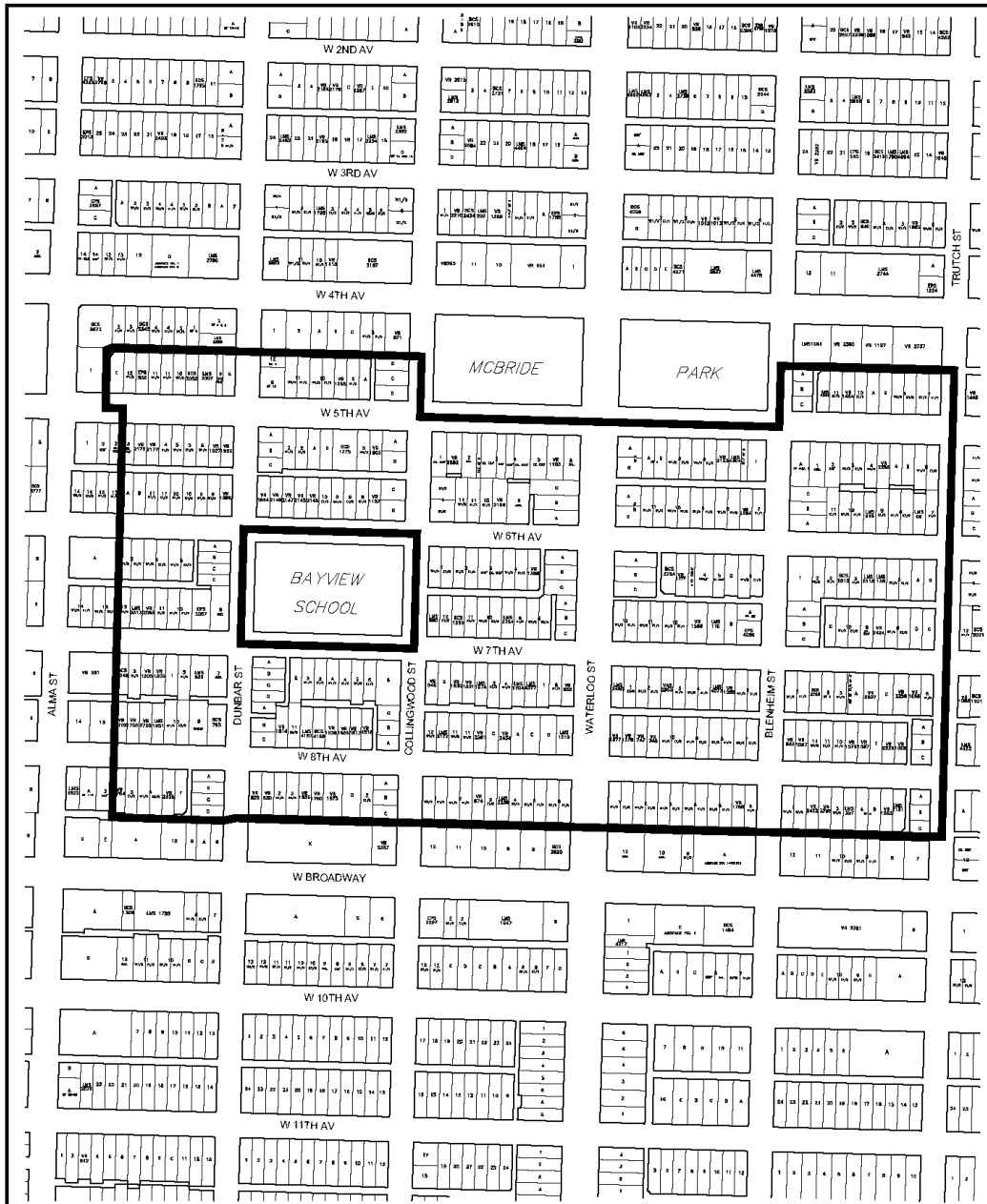

The properties outlined in black (  ) are rezoned:  
 From **RT-7** to **RT-5**

**Z-745 (c) (i)**

**RZ - Kitsilano - RT-5**

map: 1 of 3

scale: NTS



**City of Vancouver**

date: 2018-06-29

**Schedule A**

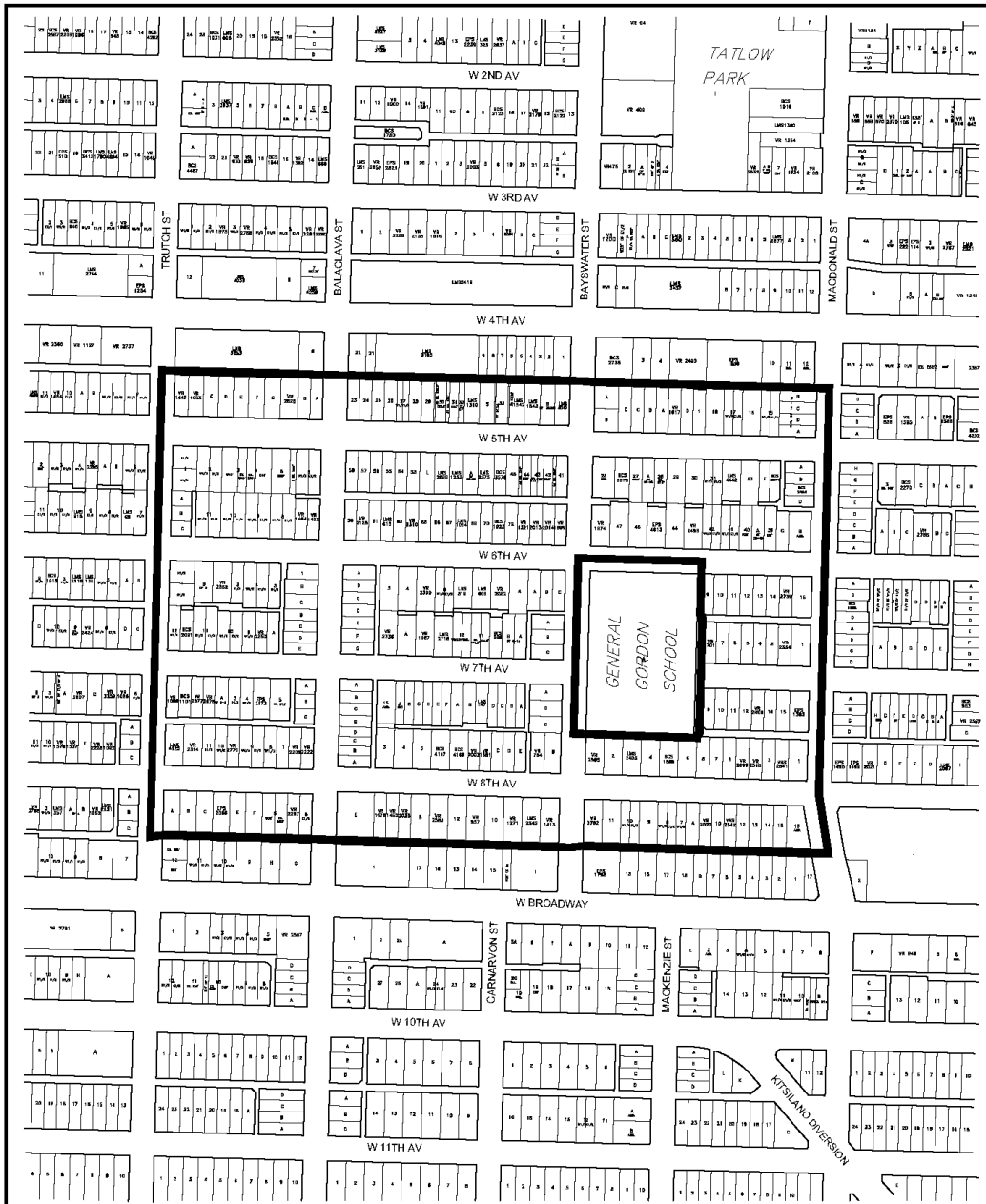

The properties outlined in black ( **▬** ) are rezoned:  
 From **RT-7** to **RT-5**

**Z-745 (c) (i)**

**RZ - Kitsilano - RT-5**

map: 2 of 3

scale: NTS



**City of Vancouver**

date: 2018-06-29

Schedule A

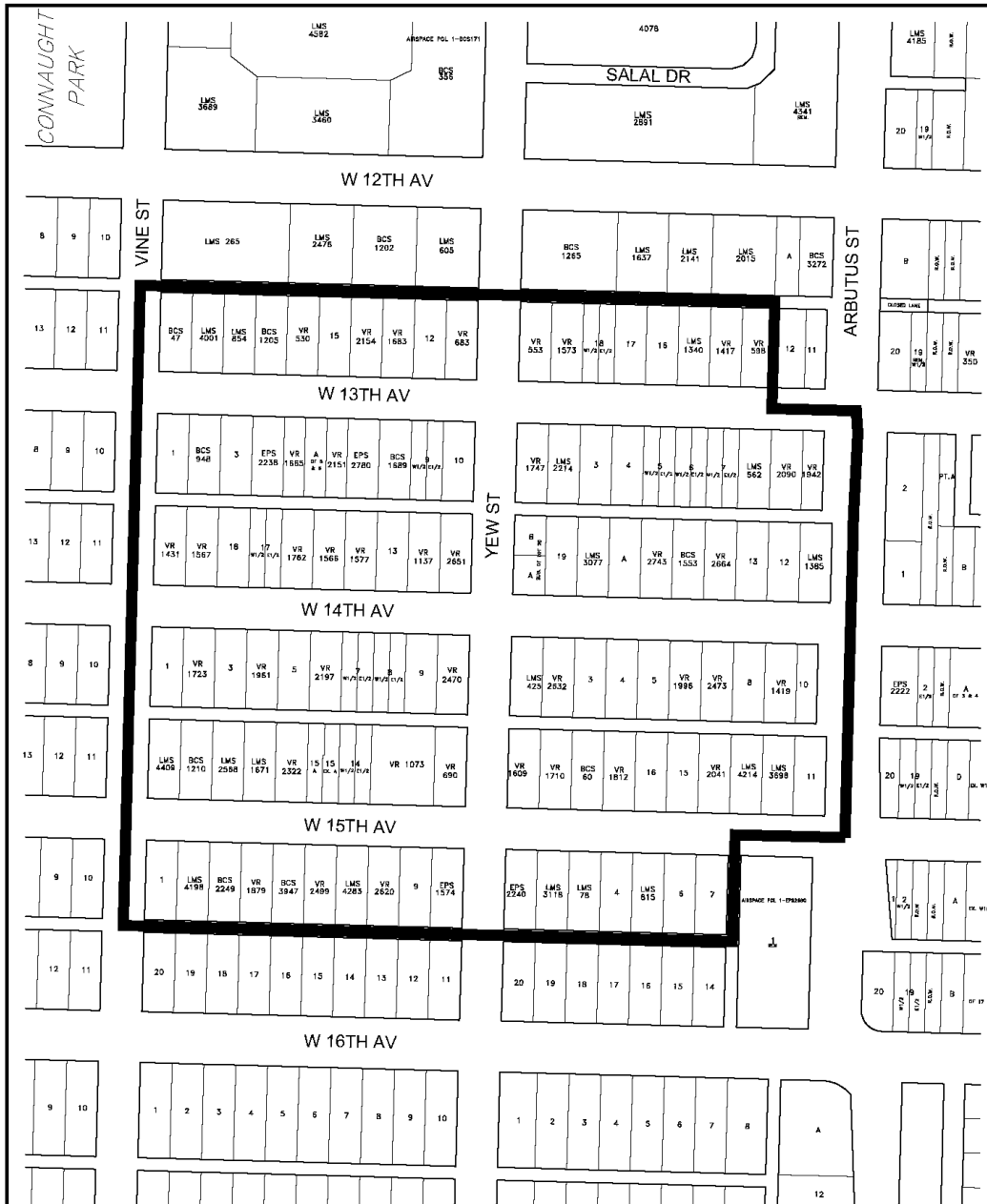

The properties outlined in black (  ) are rezoned:  
 From **RT-7** to **RT-5**

**Z-745 (c) (i)**

**RZ - Kitsilano - RT-5**

map: 3 of 3

scale: NTS



**City of Vancouver**

date: 2018-06-29

**Schedule A**

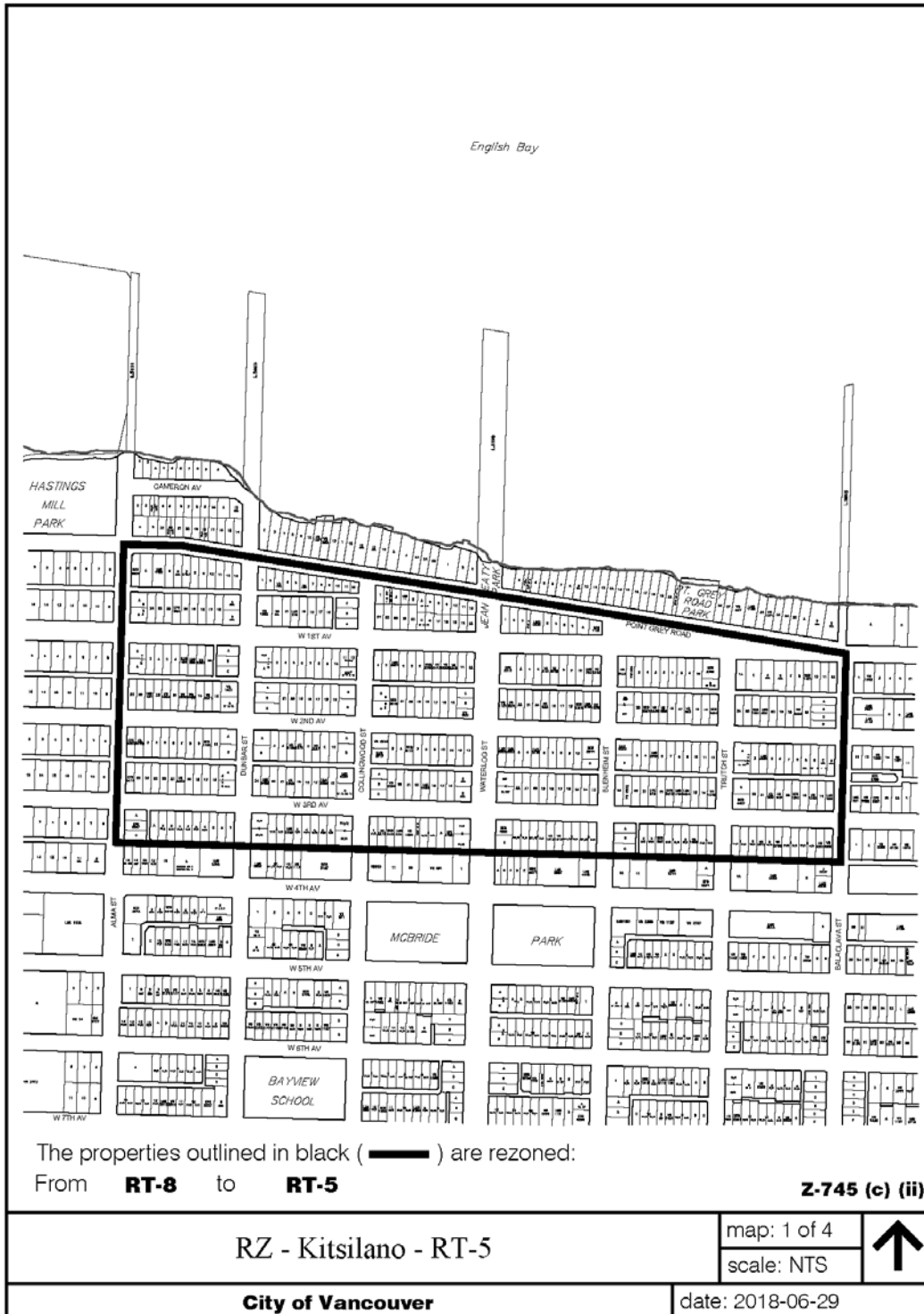

**Schedule A**

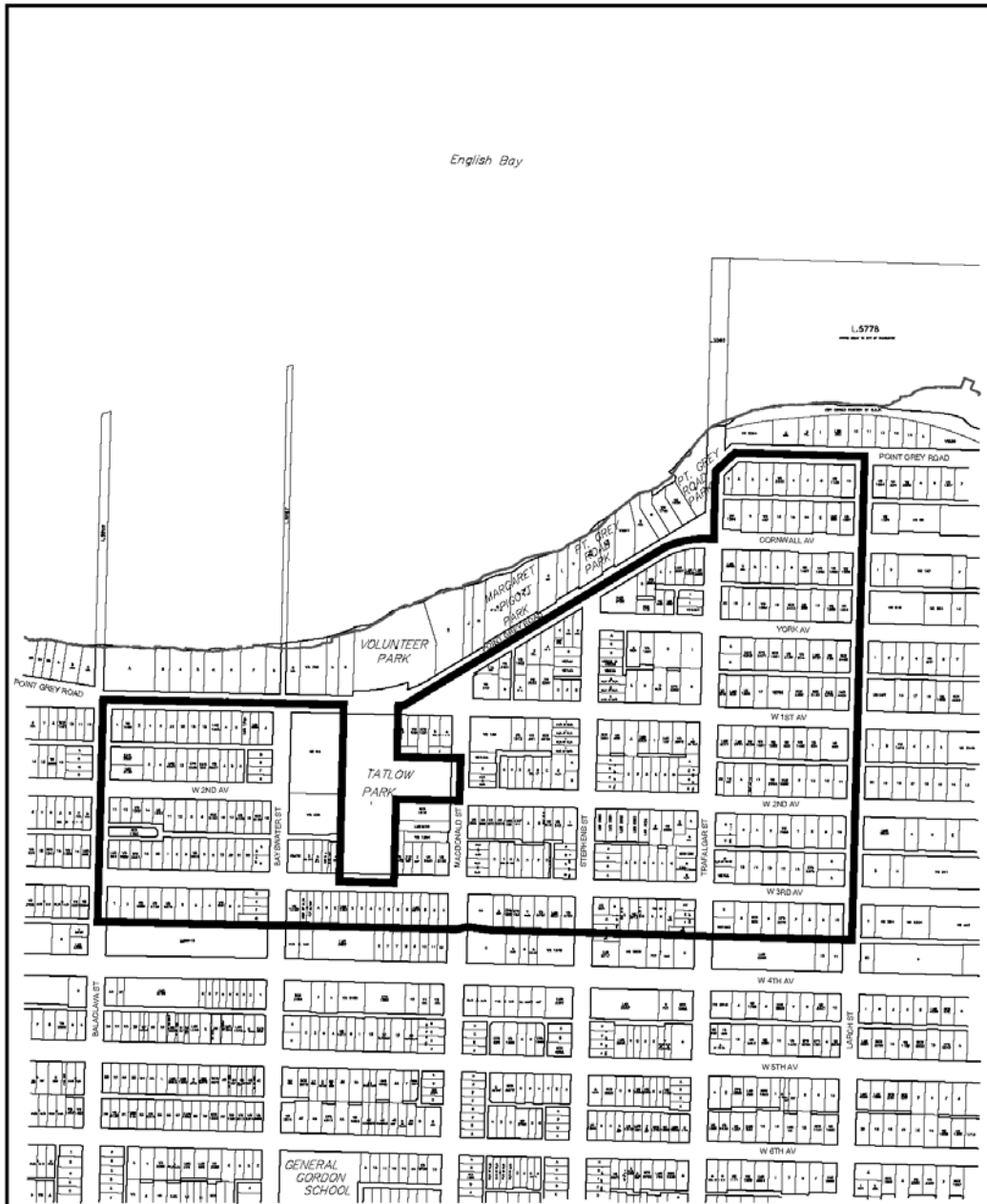

The properties outlined in black ( ——— ) are rezoned:  
 From **RT-8** to **RT-5**

**Z-745 (c) (ii)**

**RZ - Kitsilano - RT-5**

map: 2 of 4

scale: NTS



**City of Vancouver**

date: 2018-06-29

**Schedule A**

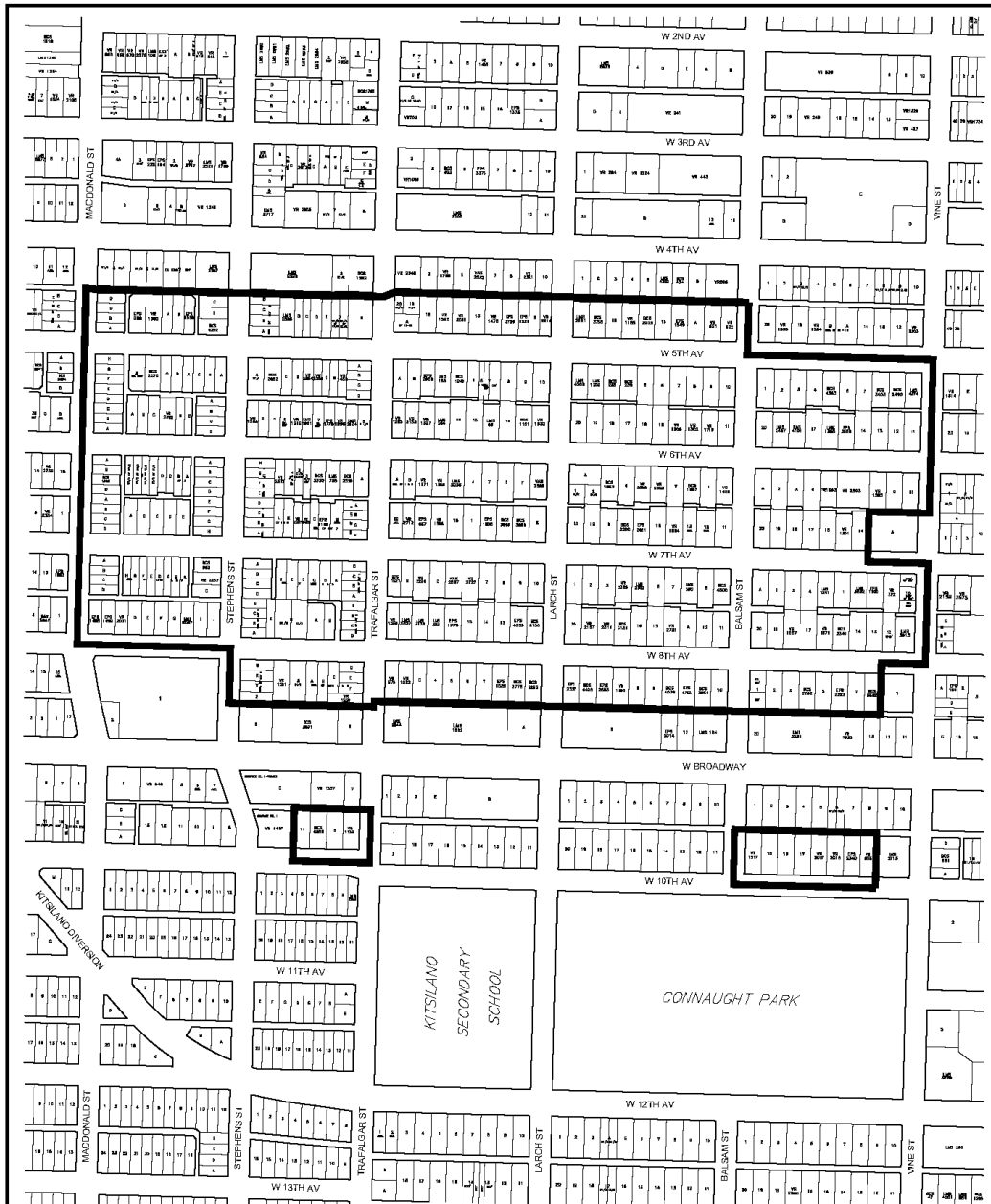

The properties outlined in black ( **——** ) are rezoned:  
 From **RT-8** to **RT-5**

**Z-745 (c) (ii)**

**RZ - Kitsilano - RT-5**

map: 3 of 4

scale: NTS



**City of Vancouver**

date: 2018-06-29



**Schedule A**

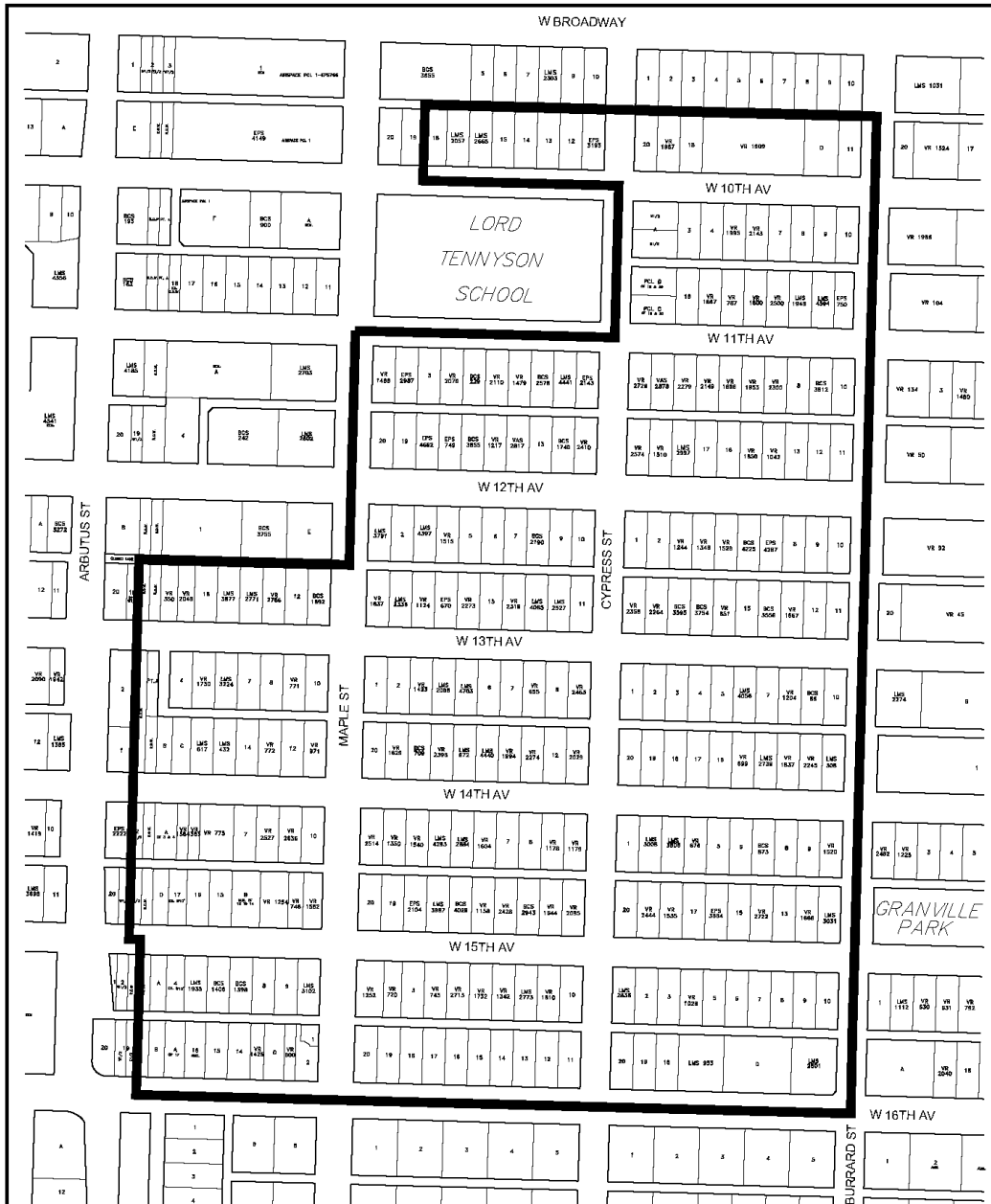

The properties outlined in black ( **█** ) are rezoned:  
 From **RT-8** to **RT-5**

**Z-745 (c) (ii)**

**RZ - Kitsilano - RT-5**

map: 4 of 4

scale: NTS



**City of Vancouver**

date: 2018-06-29

**Schedule A**



The properties outlined in black ( **█** ) are rezoned:  
 From **RT-10** to **RT-11**

**Z-745 (c) (iii)**

**RZ - Kingsway & Knight - RT-11**

map: 1 of 6

scale: NTS



**City of Vancouver**

date: 2018-06-28

**Schedule A**

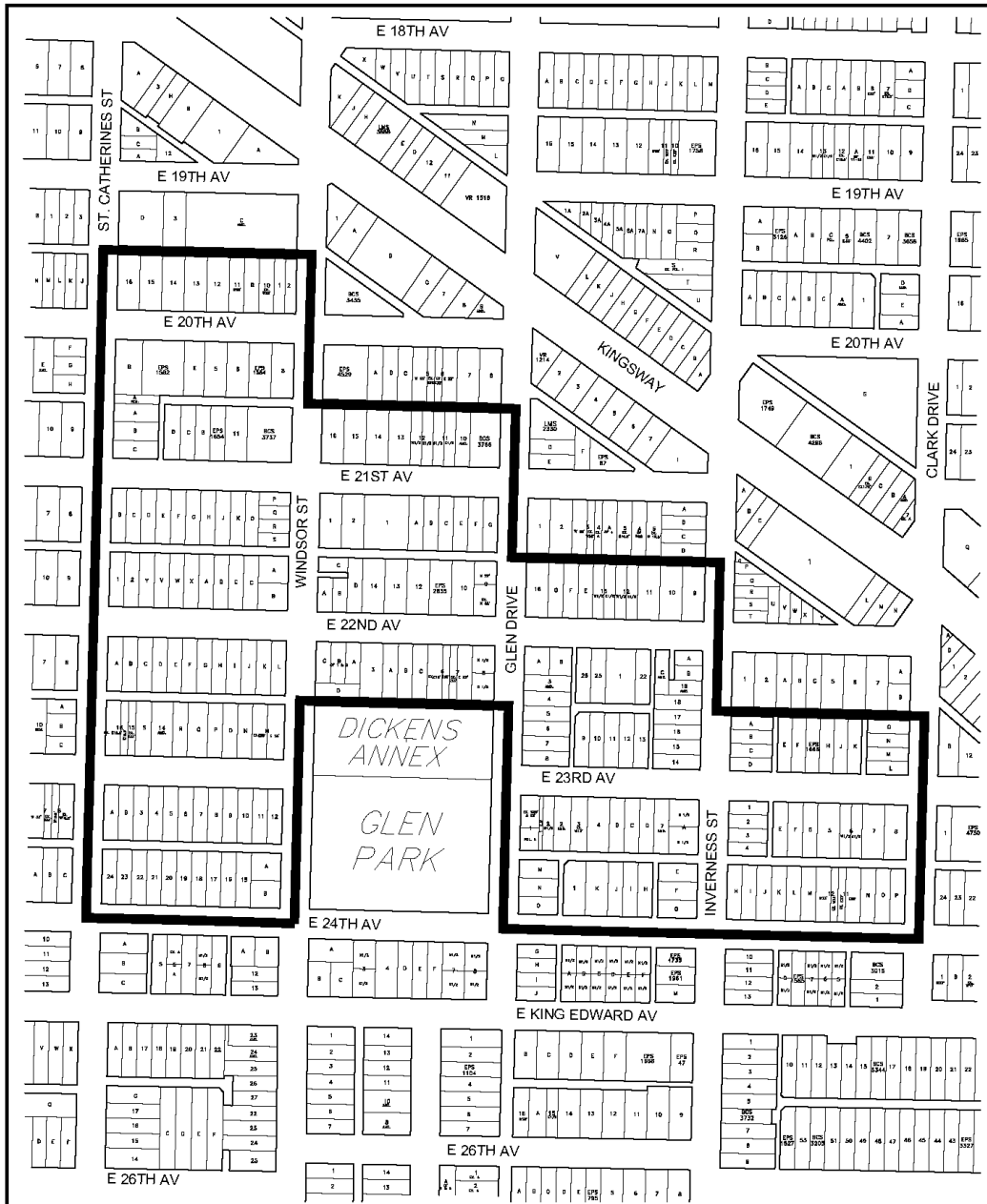

The properties outlined in black ( **█** ) are rezoned:  
 From **RT-10** to **RT-11**

**Z-745 (c) (iii)**

**RZ - Kingsway & Knight - RT-11**

map: 2 of 6

scale: NTS



**City of Vancouver**

date: 2018-06-28

Schedule A

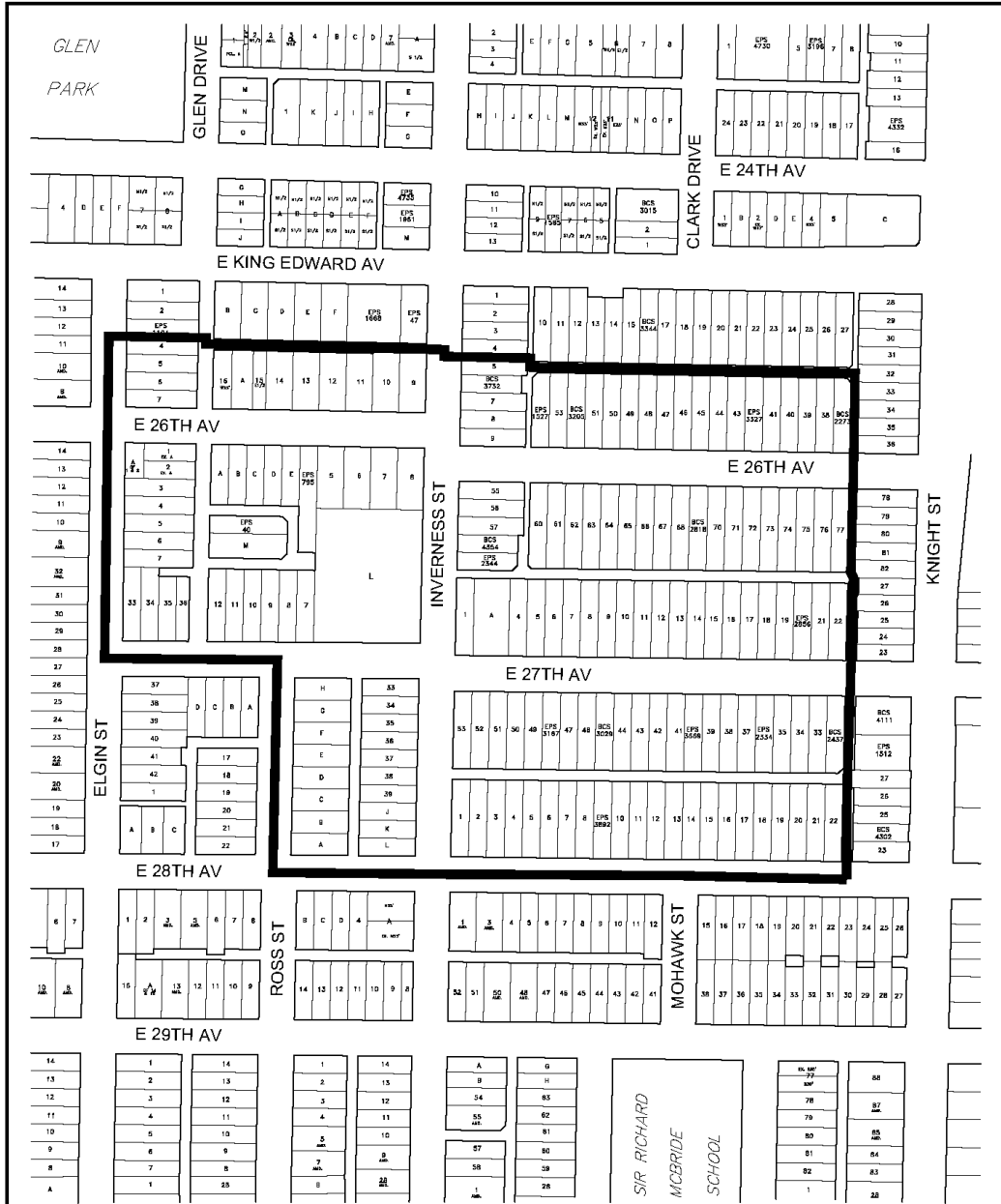

The properties outlined in black ( **█** ) are rezoned:  
 From **RT-10** to **RT-11**

**Z-745 (c) (iii)**

**RZ - Kingsway & Knight - RT-11**

map: 3 of 6

scale: NTS



**City of Vancouver**

date: 2018-06-28

**Schedule A**

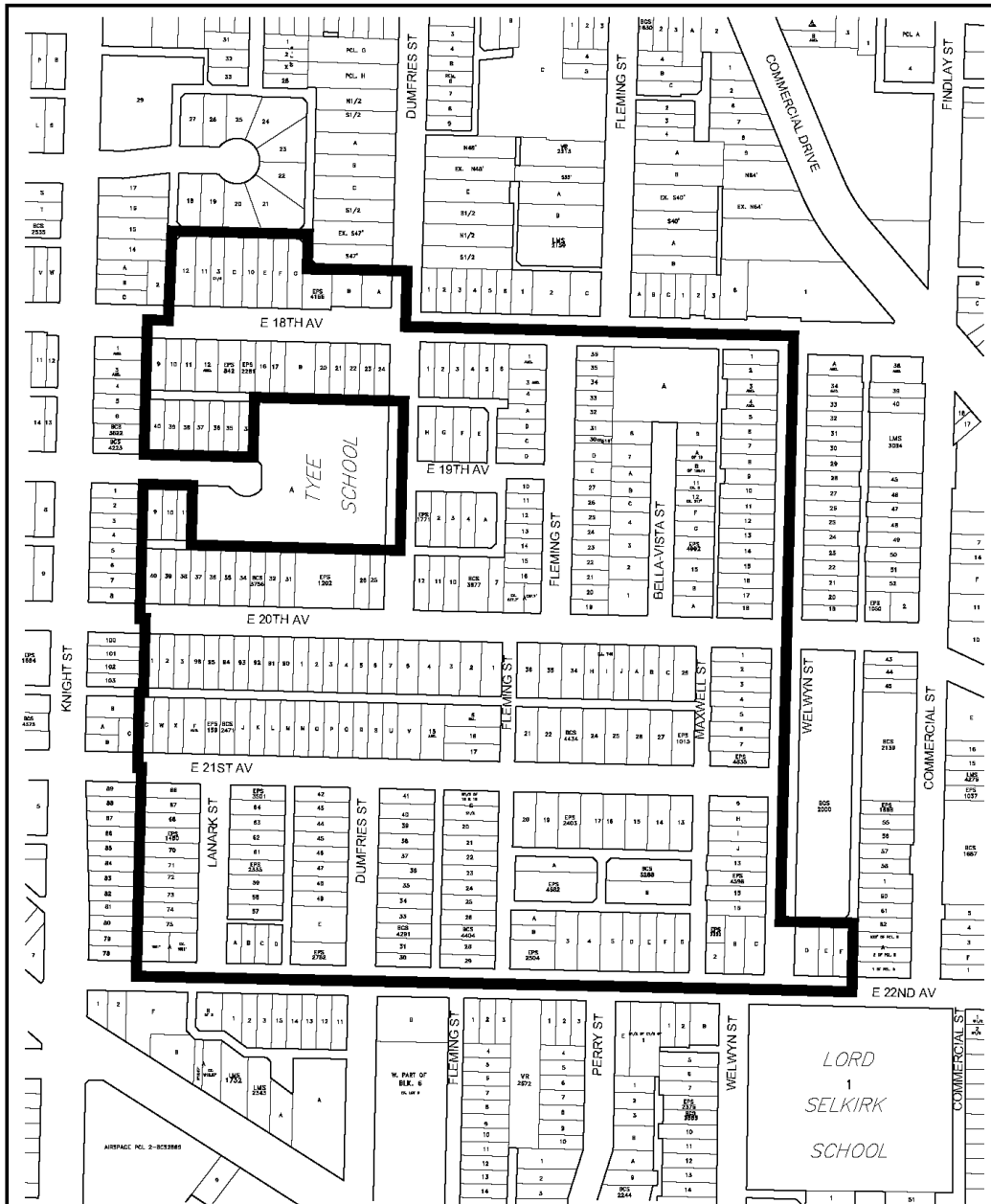

The properties outlined in black ( **█** ) are rezoned:  
 From **RT-10** to **RT-11**

**Z-745 (c) (iii)**

**RZ - Kingsway & Knight - RT-11**

map: 4 of 6

scale: NTS



**City of Vancouver**

date: 2018-06-28

Schedule A

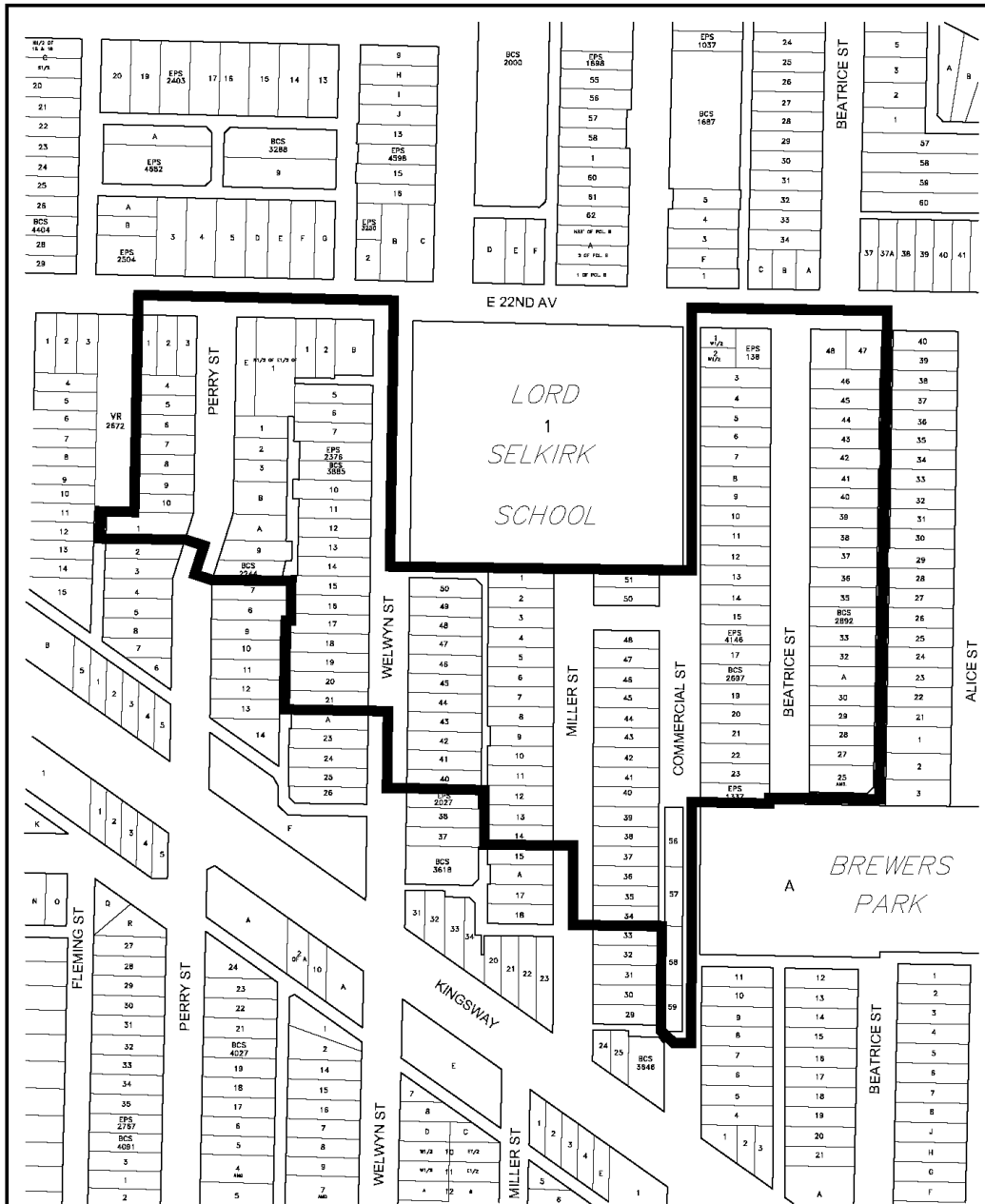

The properties outlined in black (  ) are rezoned:  
From **RT-10** to **RT-11**

**Z-745 (c) (iii)**

**RZ - Kingsway & Knight - RT-11**

map: 5 of 6

scale: NTS



**City of Vancouver**

date: 2018-06-28

Schedule A

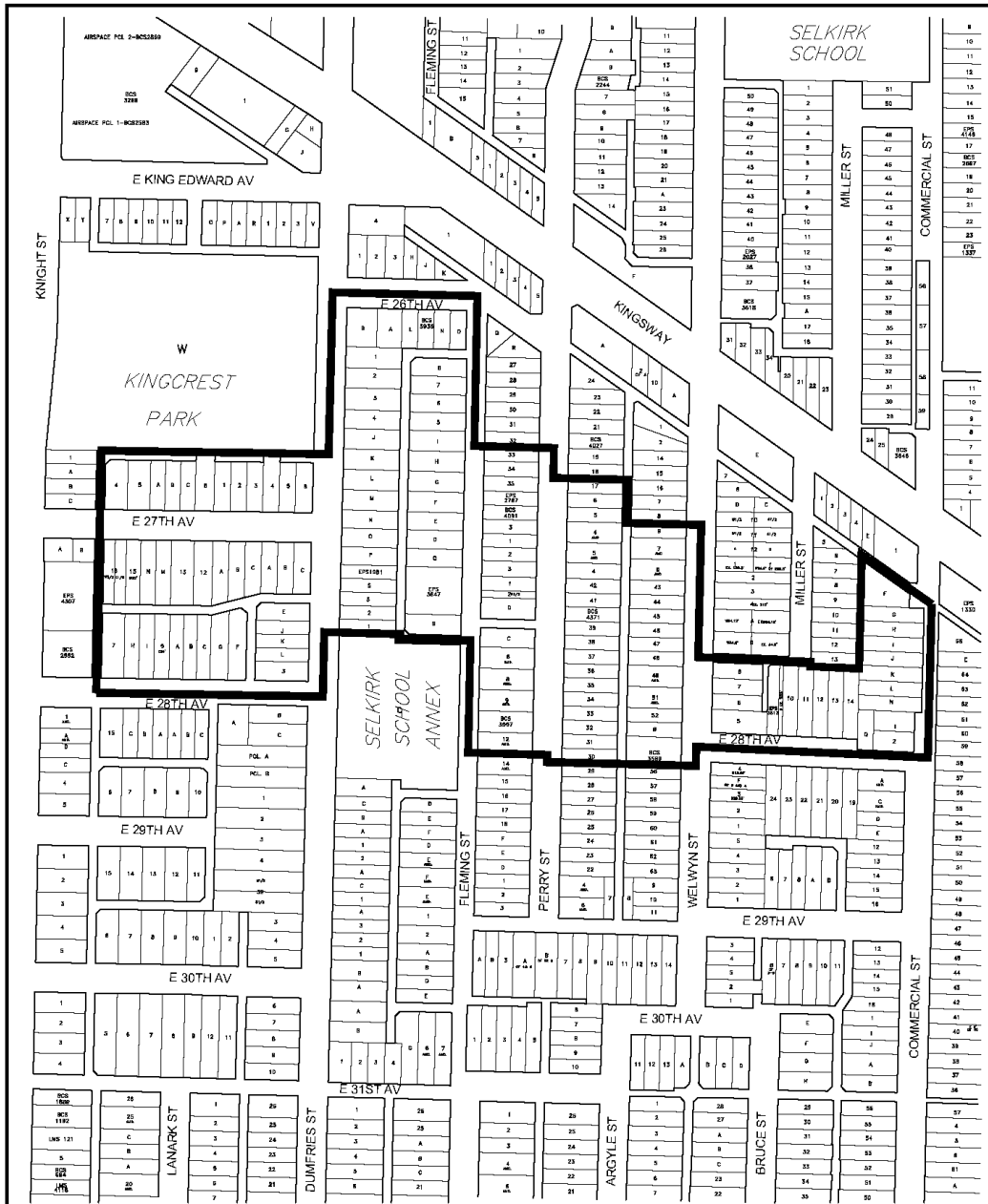

The properties outlined in black ( **█** ) are rezoned:  
 From **RT-10** to **RT-11**

**Z-745 (c) (iii)**

**RZ - Kingsway & Knight - RT-11**

map: 6 of 6

scale: NTS



**City of Vancouver**

date: 2018-06-28

**Schedule A**

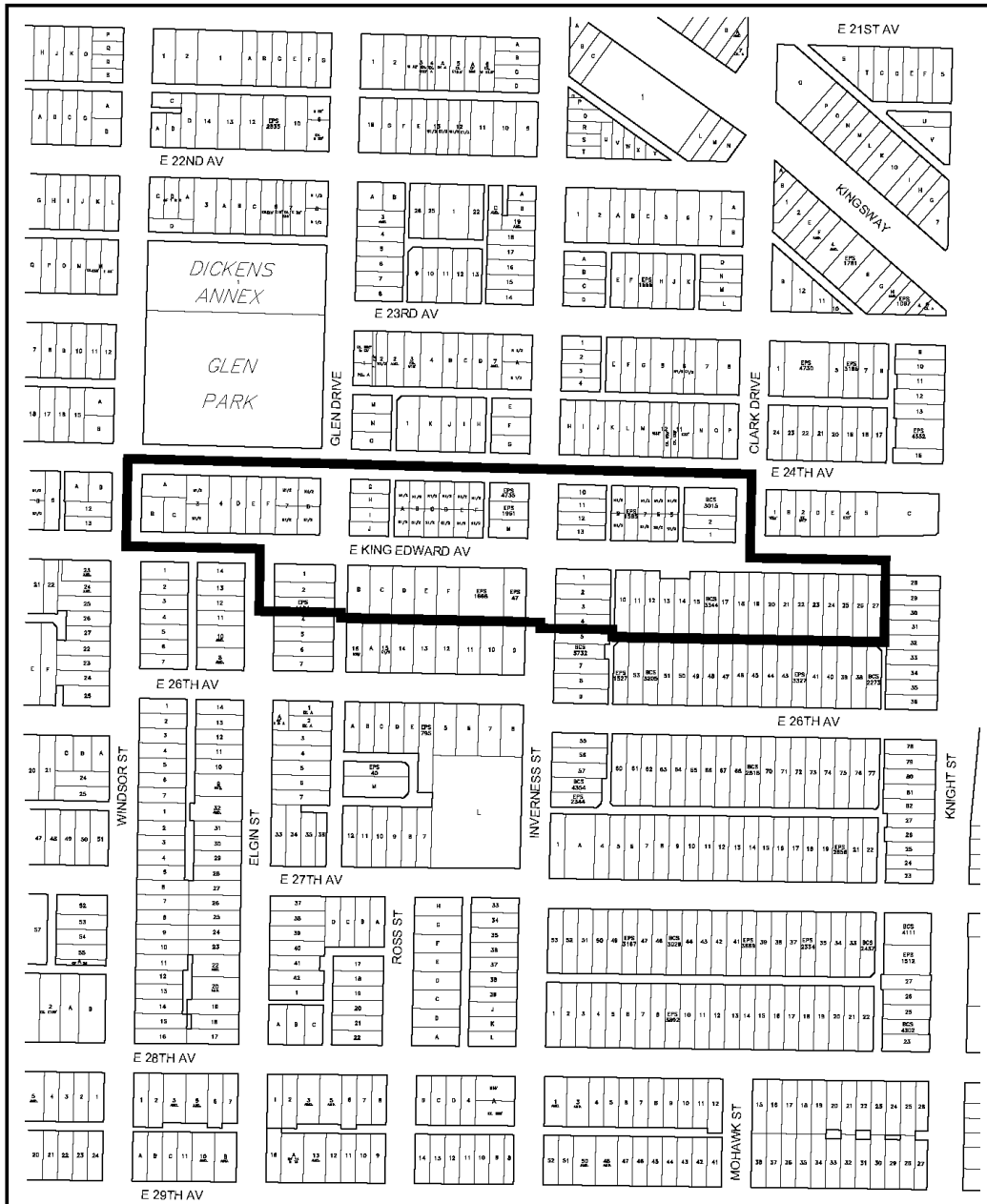

The properties outlined in black ( **█** ) are rezoned:  
 From **RT-10N** to **RT-11N**

**Z-745 (c) (iv)**

**RZ - Kingsway & Knight - RT-11N**

map: 1 of 1

scale: NTS



**City of Vancouver**

date: 2018-06-28