

BY-LAW NO. _____

**A By-law to amend
Zoning and Development By-law No. 3575
to rezone an area to CD-1**

THE COUNCIL OF THE CITY OF VANCOUVER, in public meeting, enacts as follows:

Zoning District Plan amendment

1. This By-law amends the Zoning District Plan attached as Schedule D to By-law No. 3575, and amends or substitutes the boundaries and districts shown on it, according to the amendments, substitutions, explanatory legends, notations, and references shown on the plan marginally numbered Z-675 (a) attached as Schedule A to this By-law, and incorporates Schedule A into Schedule D to By-law No. 3575.

Uses

2.1 The description of the area shown within the heavy black outline on Schedule A is CD-1 ().

2.2 Subject to Council approval of the form of development, to all conditions, guidelines and policies adopted by Council, and to the conditions set out in this By-law or in a development permit, the only uses permitted within CD-1 (), and the only uses for which the Director of Planning or Development Permit Board will issue development permits are:

- (a) Cultural and Recreational Uses, limited to Arcade, Artist Studio, Arts and Culture Indoor Event, Billiard Hall, Club, Community Centre or Neighbourhood House, Fitness Centre, Library, and Museum or Archives;
- (b) Dwelling Uses, limited to Dwelling Units in conjunction with any of the uses listed in this By-law except that no portion of the first storey of a building to a depth of 10.7 m from the north wall of the building and extending across its full width shall be used for residential purposes except for entrances to the residential portion;
- (c) Institutional Uses, limited to Child Day Care Facility and Social Service Centre;
- (d) Manufacturing Uses, limited to Jewellery Manufacturing and Printing and Publishing;
- (e) Office Uses;

- (f) Retail Uses, limited to Farmers' Market, Furniture or Appliance Store, Grocery or Drug Store, Liquor Store, Public Bike Share, Retail Store, Secondhand Store, and Small-scale Pharmacy;
- (g) Service Uses, limited to Animal Clinic, Auction Hall, Barber Shop or Beauty Salon, Beauty and Wellness Centre, Cabaret, Catering Establishment, Laundromat or Dry Cleaning Establishment, Neighbourhood Public House, Photofinishing or Photography Laboratory, Print Shop, Repair Shop - Class A, Repair Shop Class - B, Restaurant - Class 1, Restaurant - Class 2, School - Arts or Self-Improvement, School - Business, School - Vocational or Trade, and Wedding Chapel;
- (h) Transportation and Storage Uses, limited to Transit/Bus Station;
- (i) Utility and Communication Uses, limited to Public Utility or Radiocommunication Station; and
- (j) Accessory uses customarily ancillary to the uses permitted in this Section.

Conditions of use

- 3. The design and layout of at least 25% of the dwelling units must:
 - (a) be suitable for family housing;
 - (b) include two or more bedrooms; and
 - (c) comply with Council's "High Density Housing for Families with Children Guidelines".

Floor area and density

- 4.1 Computation of floor space ratio must assume that the site consists of 1,703 m².
- 4.2 Floor space ratio for all uses must not exceed 3.51.
- 4.3 Computation of floor area must include all floors, including earthen floors, above and below ground level, having a minimum ceiling height of 1.2 m, measured to the extreme outer limits of the building.
- 4.4 Computation of floor area must exclude:
 - (a) enclosed residential balconies, provided that the Director of Planning first considers all applicable policies and guidelines adopted by Council and approves the design of any balcony enclosure, except that:
 - (i) the total area of all open and enclosed balcony or sundeck exclusion does not exceed 8% of the residential floor area being provided; and

- (ii) no more than 50% of the excluded balcony floor area may be enclosed;
- (b) patios and roof gardens, provided that the Director of Planning first approves the design of sunroofs and walls, or similar features;
- (c) where floors are used for off-street parking and loading, the taking on or discharging of passengers, bicycle storage, heating and mechanical equipment or uses, which in the opinion of the Director of Planning are similar to the foregoing, those floors or portions of floors so used, which are at or below base surface, provided that the maximum exclusion for a parking space shall not exceed 7.3 m in length; and
- (d) all residential storage space above or below base surface, except that if the residential storage space above base surface exceeds 3.7 m² per dwelling unit, there will be no exclusion for any of the residential storage space above base surface for that unit.

4.5 Computation of floor area may exclude amenity areas, except that the total exclusion must not exceed the lesser of 20% of permitted floor area or 929 m².

4.6 The use of floor area excluded under section 4.4 and 4.5 must not include any purpose other than that which justified the exclusion.

Building height

5. The building height, measured from base surface, must not exceed 28.7 m, with the top of parapet not to exceed 28 m.

Horizontal angle of daylight

6.1 Each habitable room must have at least one window on an exterior wall of a building.

6.2 The location of each such exterior window must allow a plane or planes extending from the window and formed by an angle of 50 degrees, or two angles with a sum of 70 degrees, to encounter no obstruction over a distance of 24.0 m.

6.3 Measurement of the plane or planes referred to in section 6.2 must be horizontally from the centre of the bottom of each window.

6.4 If:

- (a) the Director of Planning or Development Permit Board first considers all applicable policies and guidelines adopted by Council; and
- (b) the minimum distance of unobstructed view is not less than 3.7 m,

the Director of Planning or Development Permit Board may relax the horizontal angle of daylight requirement.

- 6.5 An obstruction referred to in section 6.2 means:
- (a) any part of the same building including permitted projections; or
 - (b) the largest building permitted under the zoning on any site adjoining CD-1 ().
- 6.6 A habitable room referred to in section 6.1 does not include:
- (a) a bathroom; or
 - (b) a kitchen whose floor area is the lesser of:
 - (i) 10% or less of the total floor area of the dwelling unit, or
 - (ii) 9.3 m².

Acoustics

7. All development permit applications require evidence in the form of a report and recommendations prepared by a person trained in acoustics and current techniques of noise measurement, demonstrating that the noise levels in those portions of dwelling units listed below do not exceed the noise level set opposite such portions. For the purposes of this section, the noise level is the A-weighted 24-hour equivalent (Leq) sound level and is defined simply as noise level in decibels..

Portions of dwelling units	Noise levels (Decibels)
Bedrooms	35
Living, dining, recreation rooms	40
Kitchen, bathrooms, hallways	45

Severability

8. A decision by a court that any part of this By-law is illegal, void, or unenforceable severs that part from this By-law, and is not to affect the balance of this By-law.

Force and Effect

9. This By-law is to come into force and take effect on the date of its enactment.

ENACTED by Council this _____ day of _____, 2014

Mayor

City Clerk

Schedule A

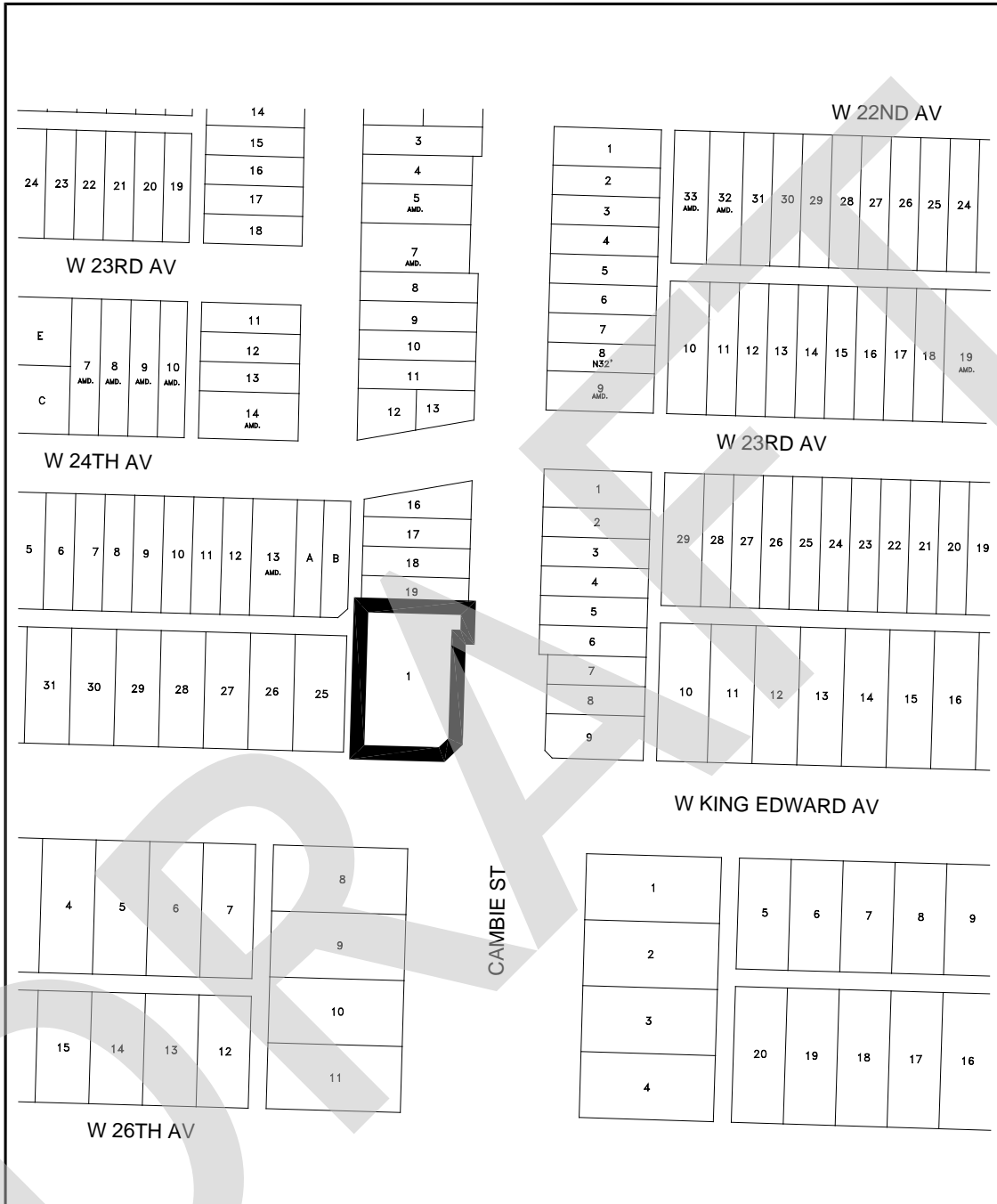

The property outlined in black (**█**) is rezoned:
From C-2 to CD-1

Z-675 (a)

RZ - 4099 Cambie Street

map: 1 of 1

scale: NTS



City of Vancouver

date: 2014-03-21