



CAMBIE STREET

STATUTORY RIGHT OF WAY (EXPLANATORY PLAN 17586), NOW ROAD

30.48m  
(100 FT.)

STATUTORY RIGHT OF WAY  
(EXPLANATORY PLAN 18707) TO BE  
GIVEN OVER TO G.V.D. & S.S.

3  
REM.  
PLAN 21466

LMS1109

VR2443

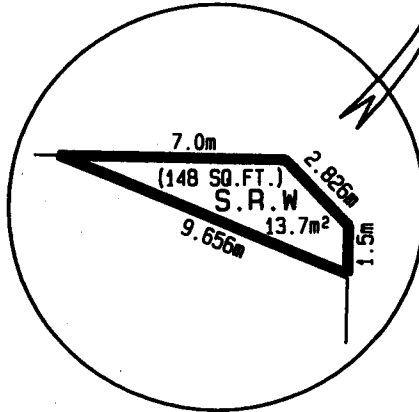

4  
REM.  
PLAN 21466

TRUNK LINE

12TH AVENUE

B

PLAN 15741

7

1276

6

5

4

3

2

1

PLAN

ASH STREET