

--- ZONING BOUNDARY

600 BEACH CRESCENT DE 407194

CITY OF VANCOUVER PLANNING DEPARTMENT

DATE 2003 03 04

DRAWN AGM

SCALE 1:2000



NO. DESCRIPTION	DATE
1. SITE PLAN FOR CONCEPT OF	11/18/12
2. LANDSCAPE PLAN	
3. AS SHOWN IN RESPONSE TO	
4. BLDG 000 SITE PLAN	
5. BLDG 000 SITE PLAN	
6. BLDG 000 SITE PLAN	
7. BLDG 000 SITE PLAN	
8. BLDG 000 SITE PLAN	
9. BLDG 000 SITE PLAN	
10. BLDG 000 SITE PLAN	
11. BLDG 000 SITE PLAN	
12. BLDG 000 SITE PLAN	
13. BLDG 000 SITE PLAN	
14. BLDG 000 SITE PLAN	
15. BLDG 000 SITE PLAN	
16. BLDG 000 SITE PLAN	
17. BLDG 000 SITE PLAN	
18. BLDG 000 SITE PLAN	
19. BLDG 000 SITE PLAN	
20. BLDG 000 SITE PLAN	

PROJECT NO. 0152

BUSBY + ASSOCIATES ARCHITECTS

1225 Market Street
 San Francisco, CA 94102
 Tel: 415.774.1100

CONCORD PACIFIC
 BEACH CREST NEIGHBOURHOOD
 PHASE 1 - 100 SHAWVILLE DRIVE
 SAN FRANCISCO, CA

DATE: 11/18/12

SCALE: 1:200

PROJECT TITLE: SITE PLAN

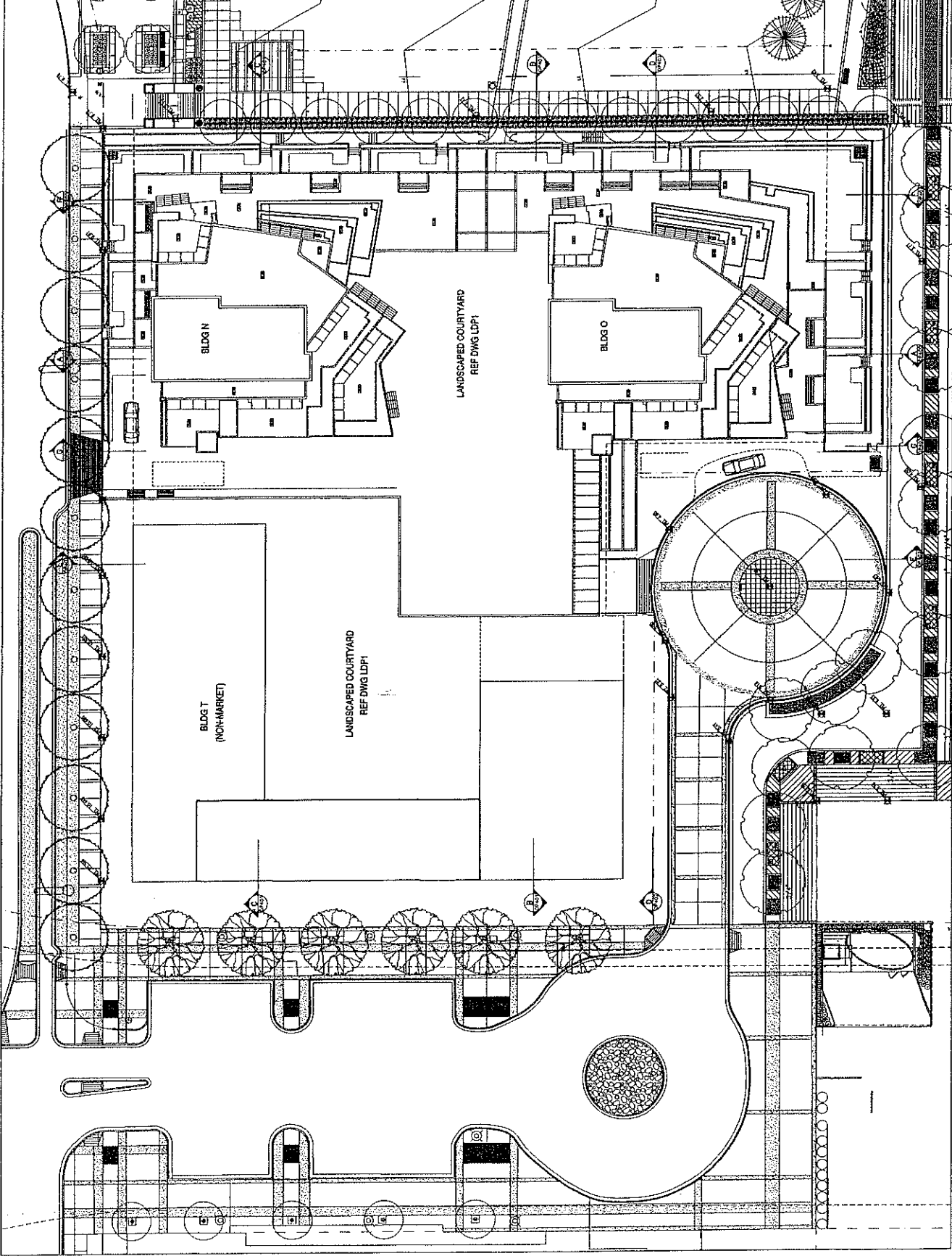

NO.	DESCRIPTION	DATE
1	REVISION	
2	REVISION	
3	REVISION	
4	REVISION	
5	REVISION	
6	REVISION	
7	REVISION	
8	REVISION	
9	REVISION	
10	REVISION	

- GENERAL NOTES**
1. ALL DIMENSIONS UNLESS OTHERWISE NOTED ARE IN FEET AND INCHES.
 2. FINISHES ARE AS SHOWN ON THE DRAWINGS.
 3. THE CONTRACTOR SHALL BE RESPONSIBLE FOR OBTAINING ALL NECESSARY PERMITS.
 4. ALL WORK SHALL BE DONE IN ACCORDANCE WITH THE LATEST EDITIONS OF THE BUILDING CODES AND SPECIFICATIONS.
 5. THE CONTRACTOR SHALL MAINTAIN ACCESS TO ALL ADJACENT PROPERTIES AT ALL TIMES.
 6. ALL MATERIALS AND WORKMANSHIP SHALL BE SUBJECT TO INSPECTION AND APPROVAL BY THE ARCHITECT.
 7. THE CONTRACTOR SHALL BE RESPONSIBLE FOR PROTECTING ALL EXISTING UTILITIES AND STRUCTURES.
 8. ALL WORK SHALL BE COMPLETED WITHIN THE SPECIFIED TIME FRAME.
 9. THE CONTRACTOR SHALL MAINTAIN A NEAT AND ORDERLY WORK SITE AT ALL TIMES.
 10. ALL MATERIALS SHALL BE STORED PROPERLY AND PROTECTED FROM THE ELEMENTS.
 11. THE CONTRACTOR SHALL BE RESPONSIBLE FOR OBTAINING ALL NECESSARY INSURANCE COVERAGE.
 12. ALL WORK SHALL BE DONE IN ACCORDANCE WITH THE LATEST EDITIONS OF THE BUILDING CODES AND SPECIFICATIONS.
 13. THE CONTRACTOR SHALL MAINTAIN ACCESS TO ALL ADJACENT PROPERTIES AT ALL TIMES.
 14. ALL MATERIALS AND WORKMANSHIP SHALL BE SUBJECT TO INSPECTION AND APPROVAL BY THE ARCHITECT.
 15. THE CONTRACTOR SHALL BE RESPONSIBLE FOR PROTECTING ALL EXISTING UTILITIES AND STRUCTURES.
 16. ALL WORK SHALL BE COMPLETED WITHIN THE SPECIFIED TIME FRAME.
 17. THE CONTRACTOR SHALL MAINTAIN A NEAT AND ORDERLY WORK SITE AT ALL TIMES.
 18. ALL MATERIALS SHALL BE STORED PROPERLY AND PROTECTED FROM THE ELEMENTS.
 19. THE CONTRACTOR SHALL BE RESPONSIBLE FOR OBTAINING ALL NECESSARY INSURANCE COVERAGE.
 20. ALL WORK SHALL BE DONE IN ACCORDANCE WITH THE LATEST EDITIONS OF THE BUILDING CODES AND SPECIFICATIONS.

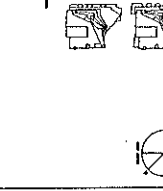

PROJECT NO. 0152
BUSBY + ASSOCIATES ARCHITECTS
 1234 Market Street
 Concord, MA 01734
 Tel: 978.338.1234
 Fax: 978.338.5678

CONCORD PACIFIC
 BEACH RESORT NEIGHBORHOOD
 12345 Main Street
 Concord, MA 01734
 Tel: 978.338.9012

EAST ELEVATION
 DRAWING TITLE

SCALE	1/2"=1'-0"
DATE	07/12/2011
DRAWN BY	JK
CHECKED BY	JK
DATE	07/12/2011

