

450 DENMAN ST. DE 403782
 425 CARDERO ST. DE 403783

DATE 1999 02 15
 DRAWN WGKS
 SCALE 1:3000



CITY OF VANCOUVER PLANNING DEPARTMENT

CONTEXT PLAN

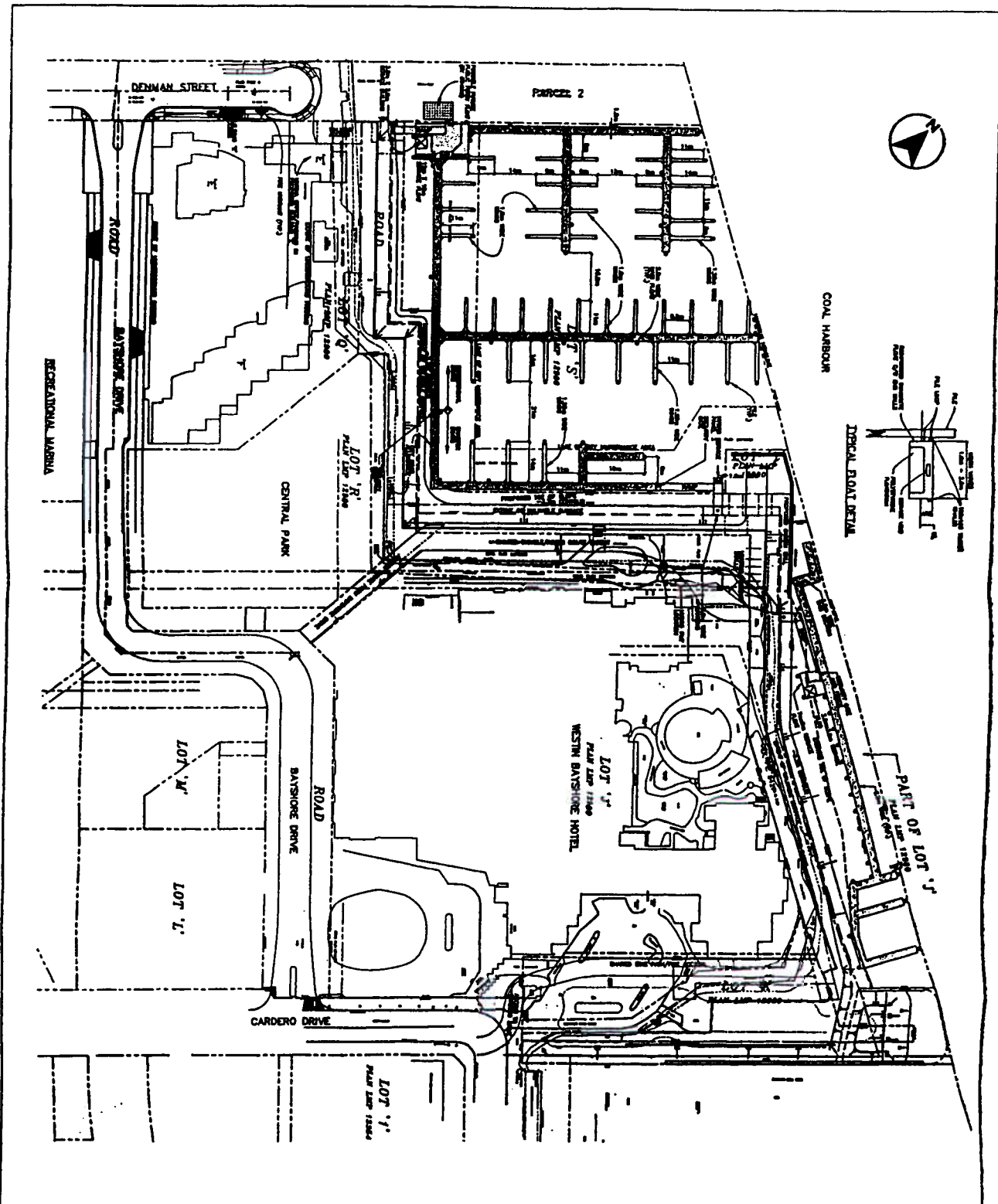

- LEGEND**
- 1. Proposed building footprint
 - 2. Proposed building footprint
 - 3. Proposed building footprint
 - 4. Proposed building footprint
 - 5. Proposed building footprint
 - 6. Proposed building footprint
 - 7. Proposed building footprint
 - 8. Proposed building footprint
 - 9. Proposed building footprint
 - 10. Proposed building footprint
 - 11. Proposed building footprint
 - 12. Proposed building footprint
 - 13. Proposed building footprint
 - 14. Proposed building footprint
 - 15. Proposed building footprint
 - 16. Proposed building footprint
 - 17. Proposed building footprint
 - 18. Proposed building footprint
 - 19. Proposed building footprint
 - 20. Proposed building footprint
 - 21. Proposed building footprint
 - 22. Proposed building footprint
 - 23. Proposed building footprint
 - 24. Proposed building footprint
 - 25. Proposed building footprint
 - 26. Proposed building footprint
 - 27. Proposed building footprint
 - 28. Proposed building footprint
 - 29. Proposed building footprint
 - 30. Proposed building footprint
 - 31. Proposed building footprint
 - 32. Proposed building footprint
 - 33. Proposed building footprint
 - 34. Proposed building footprint
 - 35. Proposed building footprint
 - 36. Proposed building footprint
 - 37. Proposed building footprint
 - 38. Proposed building footprint
 - 39. Proposed building footprint
 - 40. Proposed building footprint
 - 41. Proposed building footprint
 - 42. Proposed building footprint
 - 43. Proposed building footprint
 - 44. Proposed building footprint
 - 45. Proposed building footprint
 - 46. Proposed building footprint
 - 47. Proposed building footprint
 - 48. Proposed building footprint
 - 49. Proposed building footprint
 - 50. Proposed building footprint
 - 51. Proposed building footprint
 - 52. Proposed building footprint
 - 53. Proposed building footprint
 - 54. Proposed building footprint
 - 55. Proposed building footprint
 - 56. Proposed building footprint
 - 57. Proposed building footprint
 - 58. Proposed building footprint
 - 59. Proposed building footprint
 - 60. Proposed building footprint
 - 61. Proposed building footprint
 - 62. Proposed building footprint
 - 63. Proposed building footprint
 - 64. Proposed building footprint
 - 65. Proposed building footprint
 - 66. Proposed building footprint
 - 67. Proposed building footprint
 - 68. Proposed building footprint
 - 69. Proposed building footprint
 - 70. Proposed building footprint
 - 71. Proposed building footprint
 - 72. Proposed building footprint
 - 73. Proposed building footprint
 - 74. Proposed building footprint
 - 75. Proposed building footprint
 - 76. Proposed building footprint
 - 77. Proposed building footprint
 - 78. Proposed building footprint
 - 79. Proposed building footprint
 - 80. Proposed building footprint
 - 81. Proposed building footprint
 - 82. Proposed building footprint
 - 83. Proposed building footprint
 - 84. Proposed building footprint
 - 85. Proposed building footprint
 - 86. Proposed building footprint
 - 87. Proposed building footprint
 - 88. Proposed building footprint
 - 89. Proposed building footprint
 - 90. Proposed building footprint
 - 91. Proposed building footprint
 - 92. Proposed building footprint
 - 93. Proposed building footprint
 - 94. Proposed building footprint
 - 95. Proposed building footprint
 - 96. Proposed building footprint
 - 97. Proposed building footprint
 - 98. Proposed building footprint
 - 99. Proposed building footprint
 - 100. Proposed building footprint



Cookson Park
Engineering Ltd.
100-102
100-102

ONE
BAYSIDORE MARINA
FOOT ARRANGEMENT
PLAN

NO.	DATE	DESCRIPTION
1	10/17/2005	ISSUED FOR PERMIT
2	10/17/2005	ISSUED FOR PERMIT
3	10/17/2005	ISSUED FOR PERMIT
4	10/17/2005	ISSUED FOR PERMIT
5	10/17/2005	ISSUED FOR PERMIT
6	10/17/2005	ISSUED FOR PERMIT
7	10/17/2005	ISSUED FOR PERMIT
8	10/17/2005	ISSUED FOR PERMIT
9	10/17/2005	ISSUED FOR PERMIT
10	10/17/2005	ISSUED FOR PERMIT
11	10/17/2005	ISSUED FOR PERMIT
12	10/17/2005	ISSUED FOR PERMIT
13	10/17/2005	ISSUED FOR PERMIT
14	10/17/2005	ISSUED FOR PERMIT
15	10/17/2005	ISSUED FOR PERMIT
16	10/17/2005	ISSUED FOR PERMIT
17	10/17/2005	ISSUED FOR PERMIT
18	10/17/2005	ISSUED FOR PERMIT
19	10/17/2005	ISSUED FOR PERMIT
20	10/17/2005	ISSUED FOR PERMIT
21	10/17/2005	ISSUED FOR PERMIT
22	10/17/2005	ISSUED FOR PERMIT
23	10/17/2005	ISSUED FOR PERMIT
24	10/17/2005	ISSUED FOR PERMIT
25	10/17/2005	ISSUED FOR PERMIT
26	10/17/2005	ISSUED FOR PERMIT
27	10/17/2005	ISSUED FOR PERMIT
28	10/17/2005	ISSUED FOR PERMIT
29	10/17/2005	ISSUED FOR PERMIT
30	10/17/2005	ISSUED FOR PERMIT
31	10/17/2005	ISSUED FOR PERMIT
32	10/17/2005	ISSUED FOR PERMIT
33	10/17/2005	ISSUED FOR PERMIT
34	10/17/2005	ISSUED FOR PERMIT
35	10/17/2005	ISSUED FOR PERMIT
36	10/17/2005	ISSUED FOR PERMIT
37	10/17/2005	ISSUED FOR PERMIT
38	10/17/2005	ISSUED FOR PERMIT
39	10/17/2005	ISSUED FOR PERMIT
40	10/17/2005	ISSUED FOR PERMIT
41	10/17/2005	ISSUED FOR PERMIT
42	10/17/2005	ISSUED FOR PERMIT
43	10/17/2005	ISSUED FOR PERMIT
44	10/17/2005	ISSUED FOR PERMIT
45	10/17/2005	ISSUED FOR PERMIT
46	10/17/2005	ISSUED FOR PERMIT
47	10/17/2005	ISSUED FOR PERMIT
48	10/17/2005	ISSUED FOR PERMIT
49	10/17/2005	ISSUED FOR PERMIT
50	10/17/2005	ISSUED FOR PERMIT
51	10/17/2005	ISSUED FOR PERMIT
52	10/17/2005	ISSUED FOR PERMIT
53	10/17/2005	ISSUED FOR PERMIT
54	10/17/2005	ISSUED FOR PERMIT
55	10/17/2005	ISSUED FOR PERMIT
56	10/17/2005	ISSUED FOR PERMIT
57	10/17/2005	ISSUED FOR PERMIT
58	10/17/2005	ISSUED FOR PERMIT
59	10/17/2005	ISSUED FOR PERMIT
60	10/17/2005	ISSUED FOR PERMIT
61	10/17/2005	ISSUED FOR PERMIT
62	10/17/2005	ISSUED FOR PERMIT
63	10/17/2005	ISSUED FOR PERMIT
64	10/17/2005	ISSUED FOR PERMIT
65	10/17/2005	ISSUED FOR PERMIT
66	10/17/2005	ISSUED FOR PERMIT
67	10/17/2005	ISSUED FOR PERMIT
68	10/17/2005	ISSUED FOR PERMIT
69	10/17/2005	ISSUED FOR PERMIT
70	10/17/2005	ISSUED FOR PERMIT
71	10/17/2005	ISSUED FOR PERMIT
72	10/17/2005	ISSUED FOR PERMIT
73	10/17/2005	ISSUED FOR PERMIT
74	10/17/2005	ISSUED FOR PERMIT
75	10/17/2005	ISSUED FOR PERMIT
76	10/17/2005	ISSUED FOR PERMIT
77	10/17/2005	ISSUED FOR PERMIT
78	10/17/2005	ISSUED FOR PERMIT
79	10/17/2005	ISSUED FOR PERMIT
80	10/17/2005	ISSUED FOR PERMIT
81	10/17/2005	ISSUED FOR PERMIT
82	10/17/2005	ISSUED FOR PERMIT
83	10/17/2005	ISSUED FOR PERMIT
84	10/17/2005	ISSUED FOR PERMIT
85	10/17/2005	ISSUED FOR PERMIT
86	10/17/2005	ISSUED FOR PERMIT
87	10/17/2005	ISSUED FOR PERMIT
88	10/17/2005	ISSUED FOR PERMIT
89	10/17/2005	ISSUED FOR PERMIT
90	10/17/2005	ISSUED FOR PERMIT
91	10/17/2005	ISSUED FOR PERMIT
92	10/17/2005	ISSUED FOR PERMIT
93	10/17/2005	ISSUED FOR PERMIT
94	10/17/2005	ISSUED FOR PERMIT
95	10/17/2005	ISSUED FOR PERMIT
96	10/17/2005	ISSUED FOR PERMIT
97	10/17/2005	ISSUED FOR PERMIT
98	10/17/2005	ISSUED FOR PERMIT
99	10/17/2005	ISSUED FOR PERMIT
100	10/17/2005	ISSUED FOR PERMIT

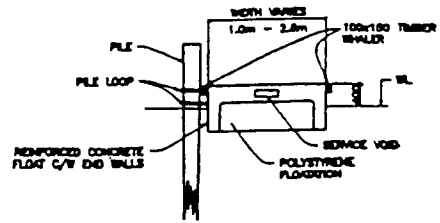

TYPICAL FLOAT DETAIL

COAL HARBOUR

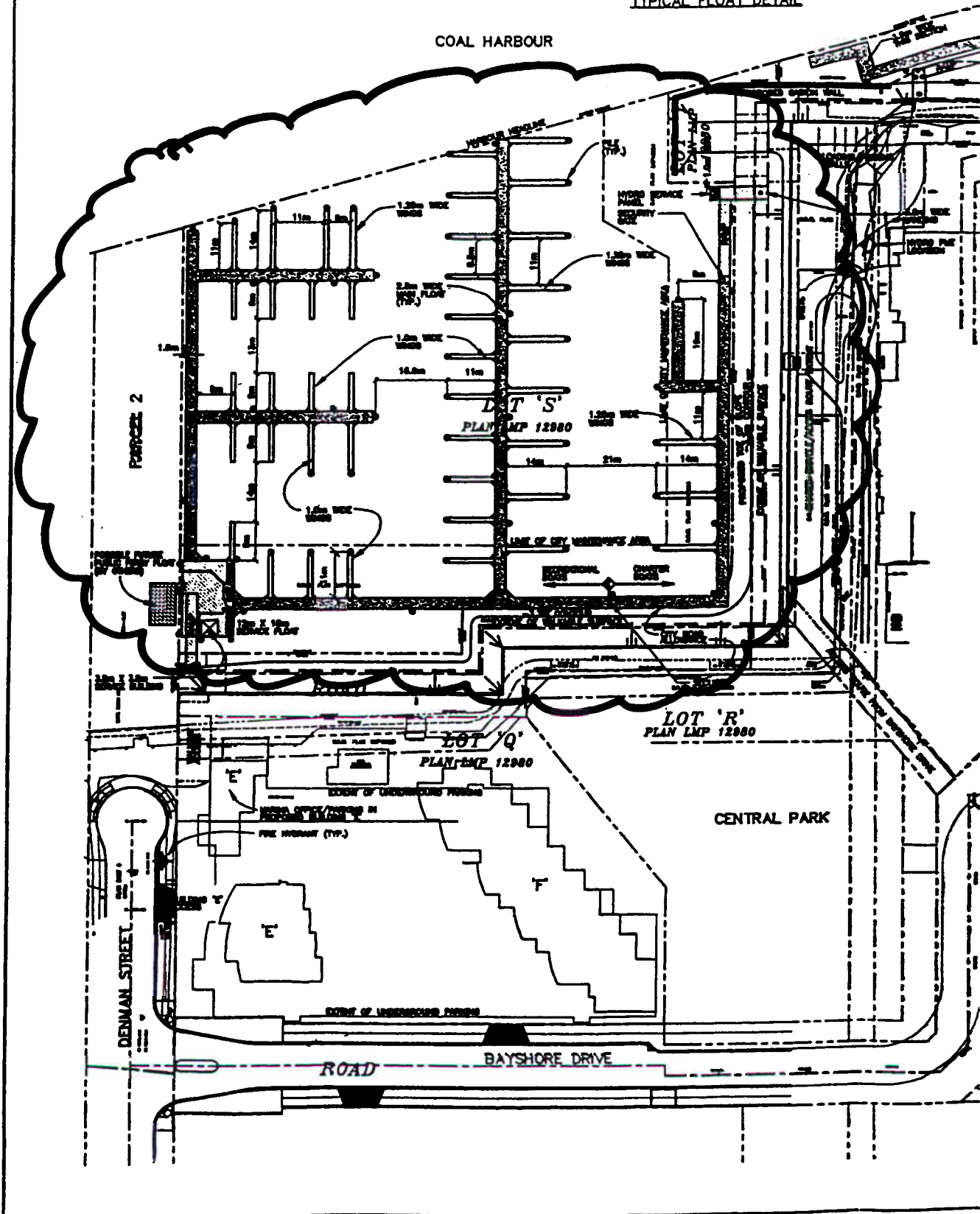

PROPOSED MARINE TERMINAL (CHARTER BOATS) - SUB AREA 4

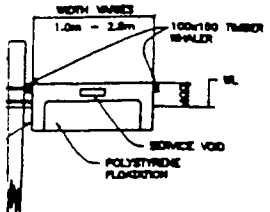

TYPICAL FLOAT DETAIL

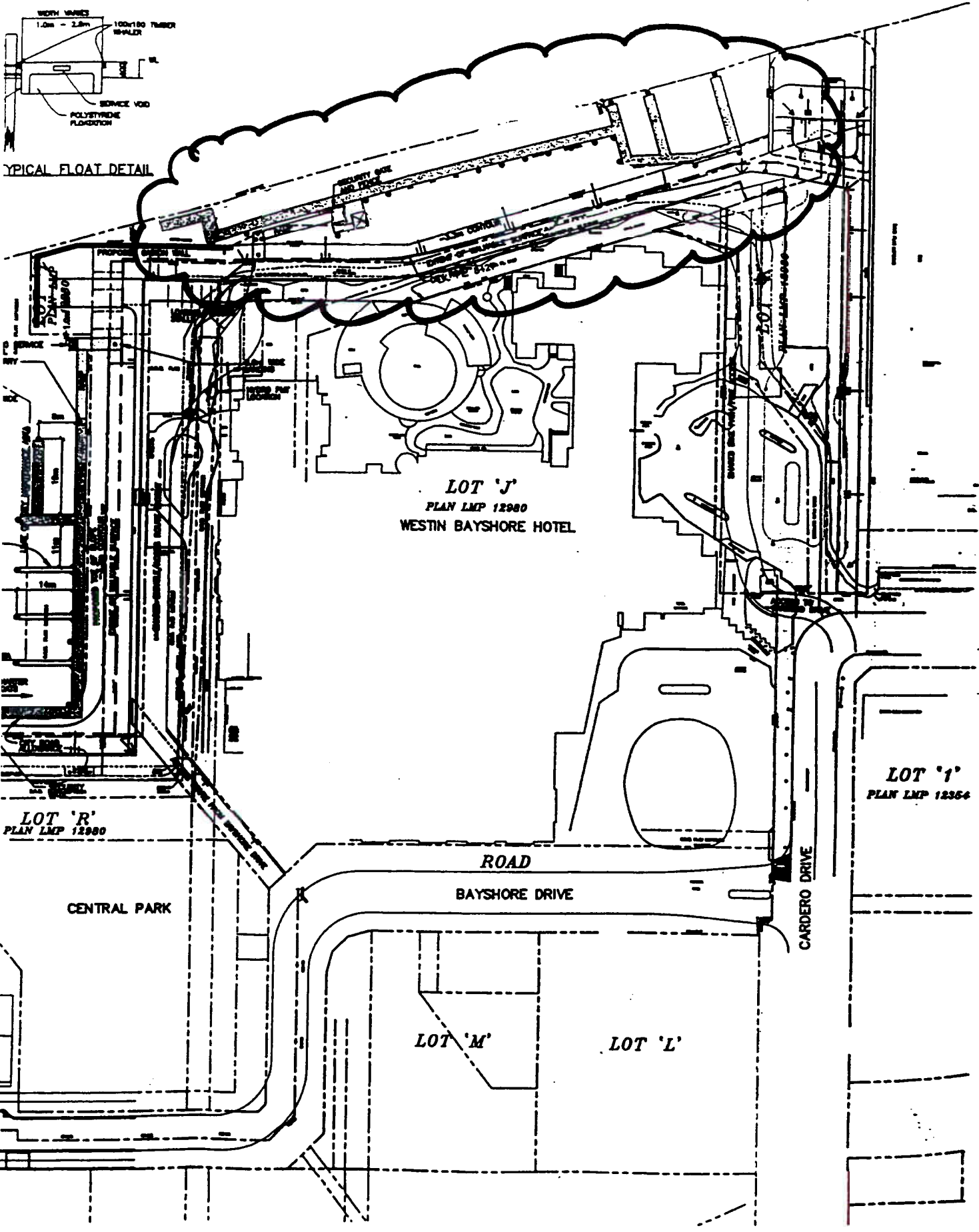

TEMPORARY MARINE TERMINAL (APPROX. 1 YEAR)- SUB AREA 5

