

Killarney Seniors Centre DESIGN-BUILD CONTRACT AWARD

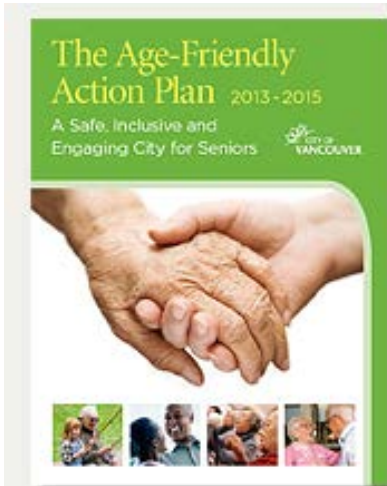
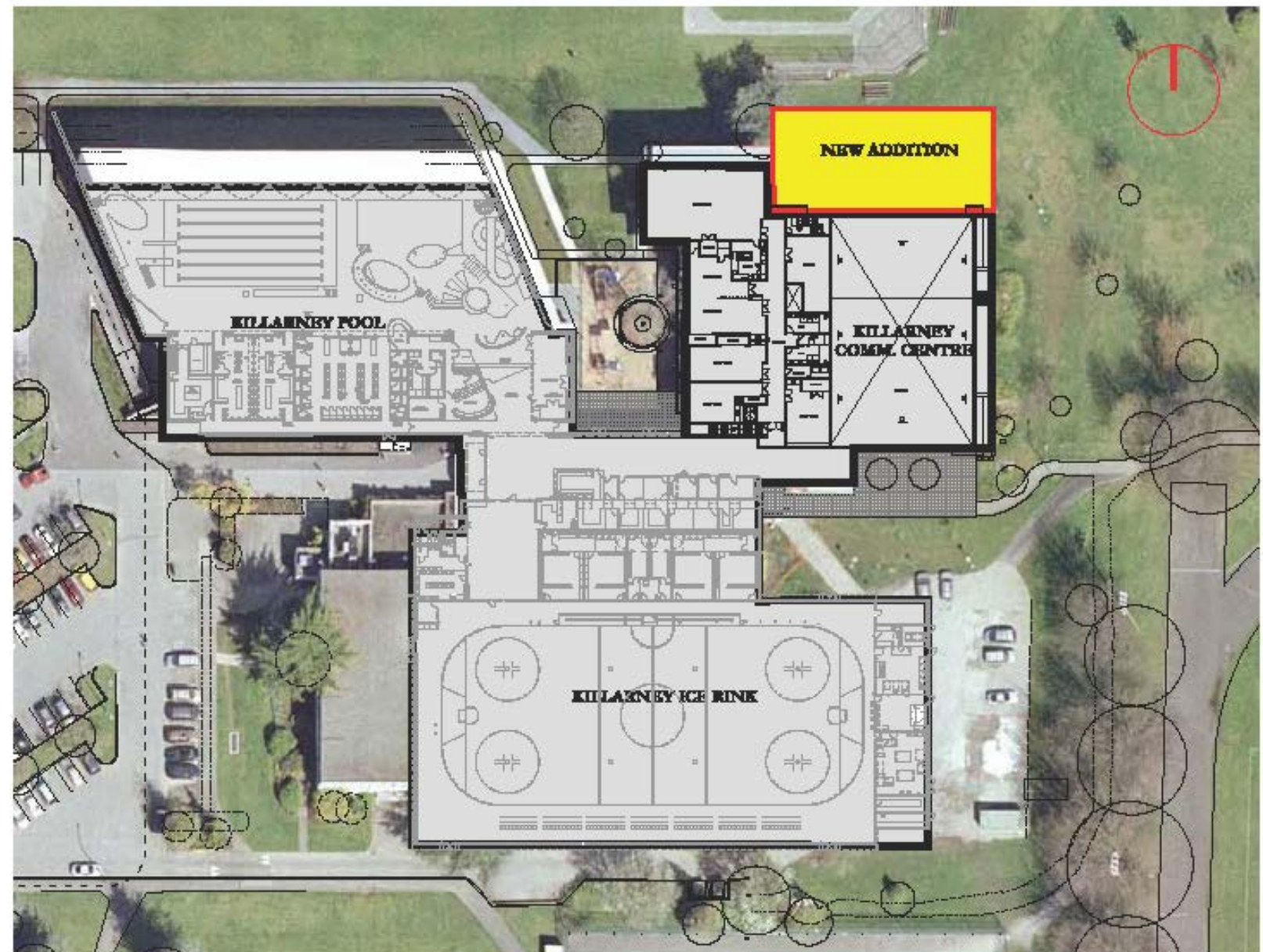

February 23 2016

Killarney Seniors Centre PROJECT BACKGROUND

- 2009 - Vancouver Park Board votes to allocate land next to the Killarney Community Centre to build a senior's centre in South East Vancouver
- 2010 - Seniors Centre Feasibility Study completed
- 2011 - \$2.5M approved by Council - RTS 8990
- 2013 - \$1.3 M approved by Province of BC
- 2014 - Additional \$1.2M approved by Province of BC
- 2014 - \$2.5 M approved by Federal gov.
- Design Build budget \$5.9m
- Design Build contract \$5.895m
- **TOTAL PROJECT BUDGET: \$7.5M**



Killarney Seniors Centre

EXISTING KILLARNEY COMMUNITY CENTRE

The existing Killarney Community Centre has three major components including:

- (a) The Community Centre designed by Henriquez Partners Architects in 1997, which includes a gymnasium, multipurpose rooms, and a community kitchen;
- (b) The Community Pool, designed by Hughes Condon Marler Architects, and opened in 2006;
- (c) The Ice Rink, designed by Acton Ostry Architects, which was completed as a practice venue for the 2010 Olympics.

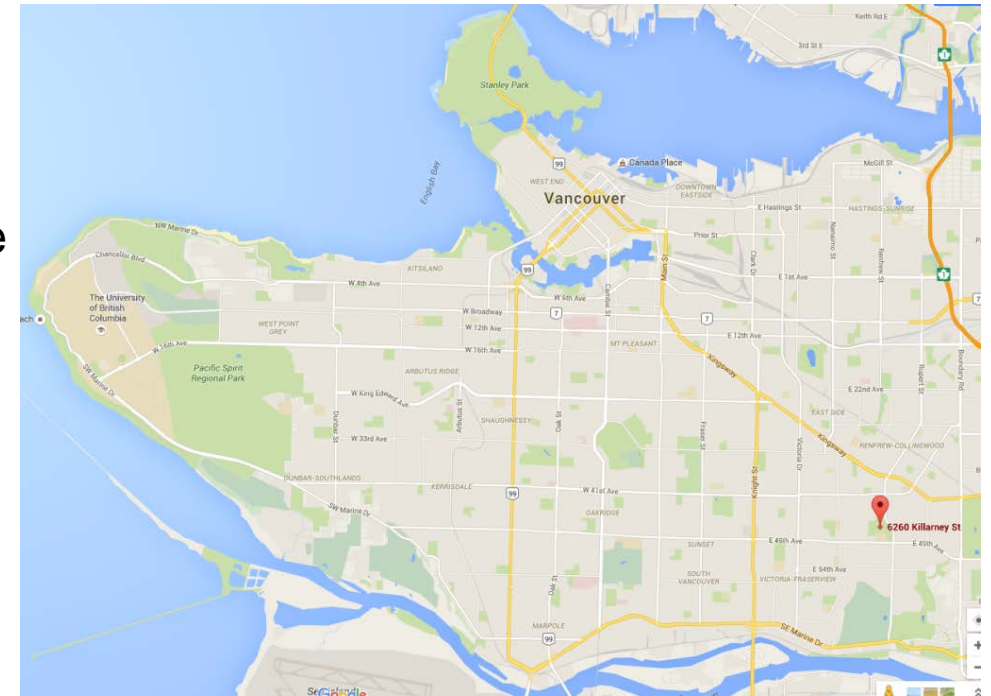

Killarney Seniors Centre

PROJECT LOCATION & FLOOR PLANS

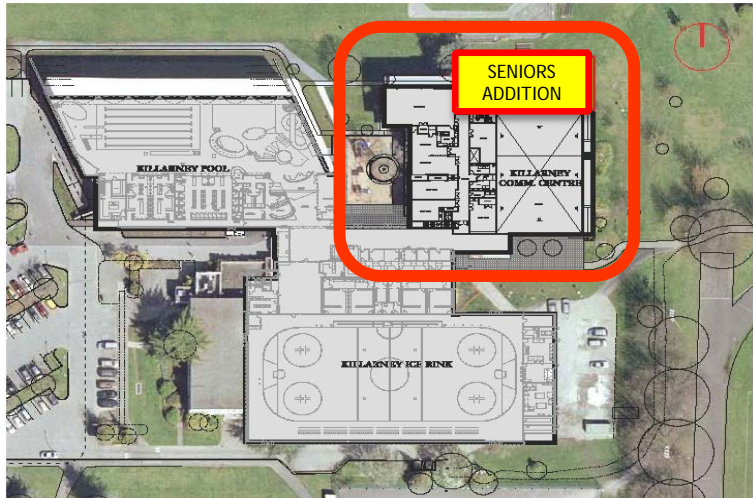

Site Plan

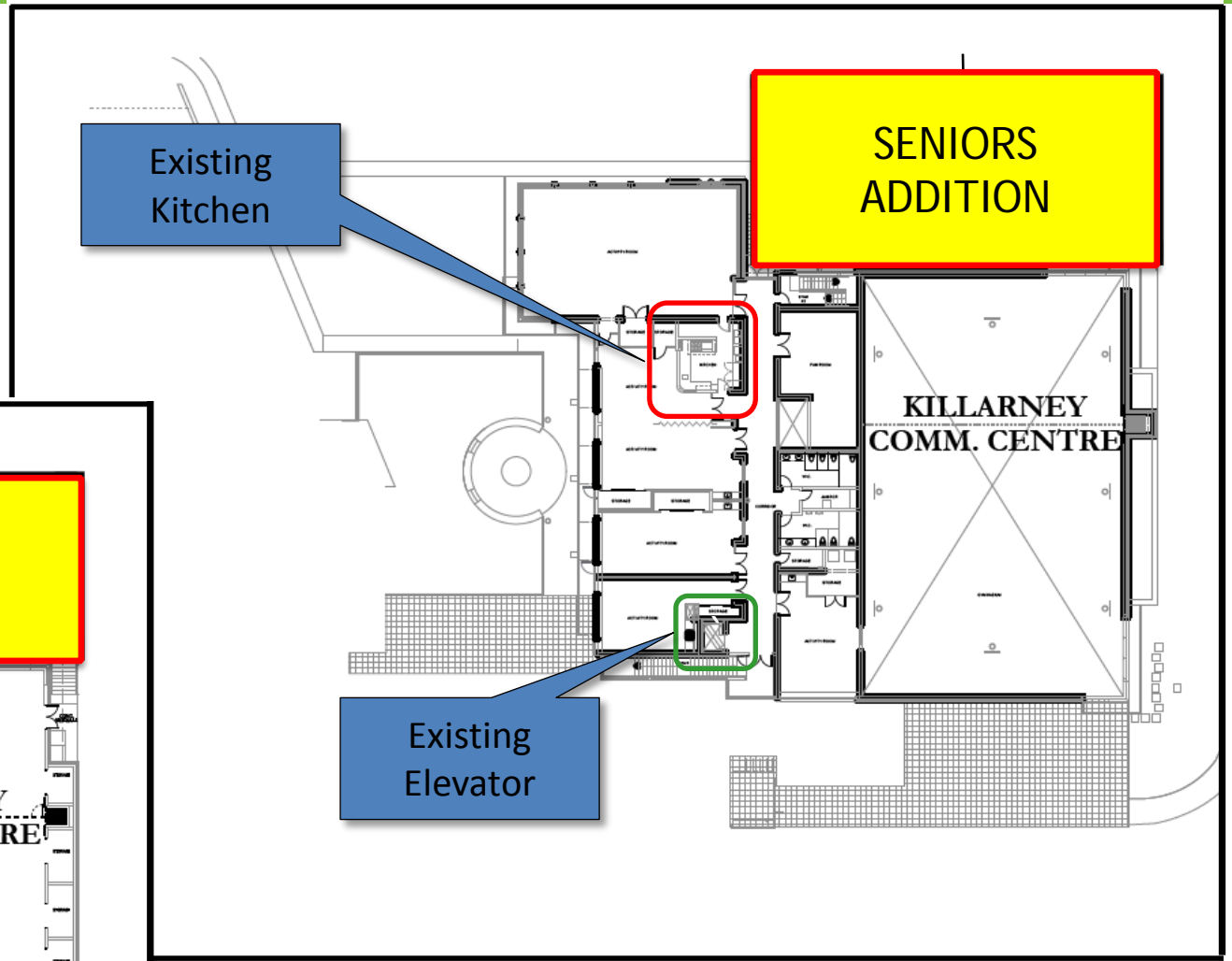

Upper Floor Plan

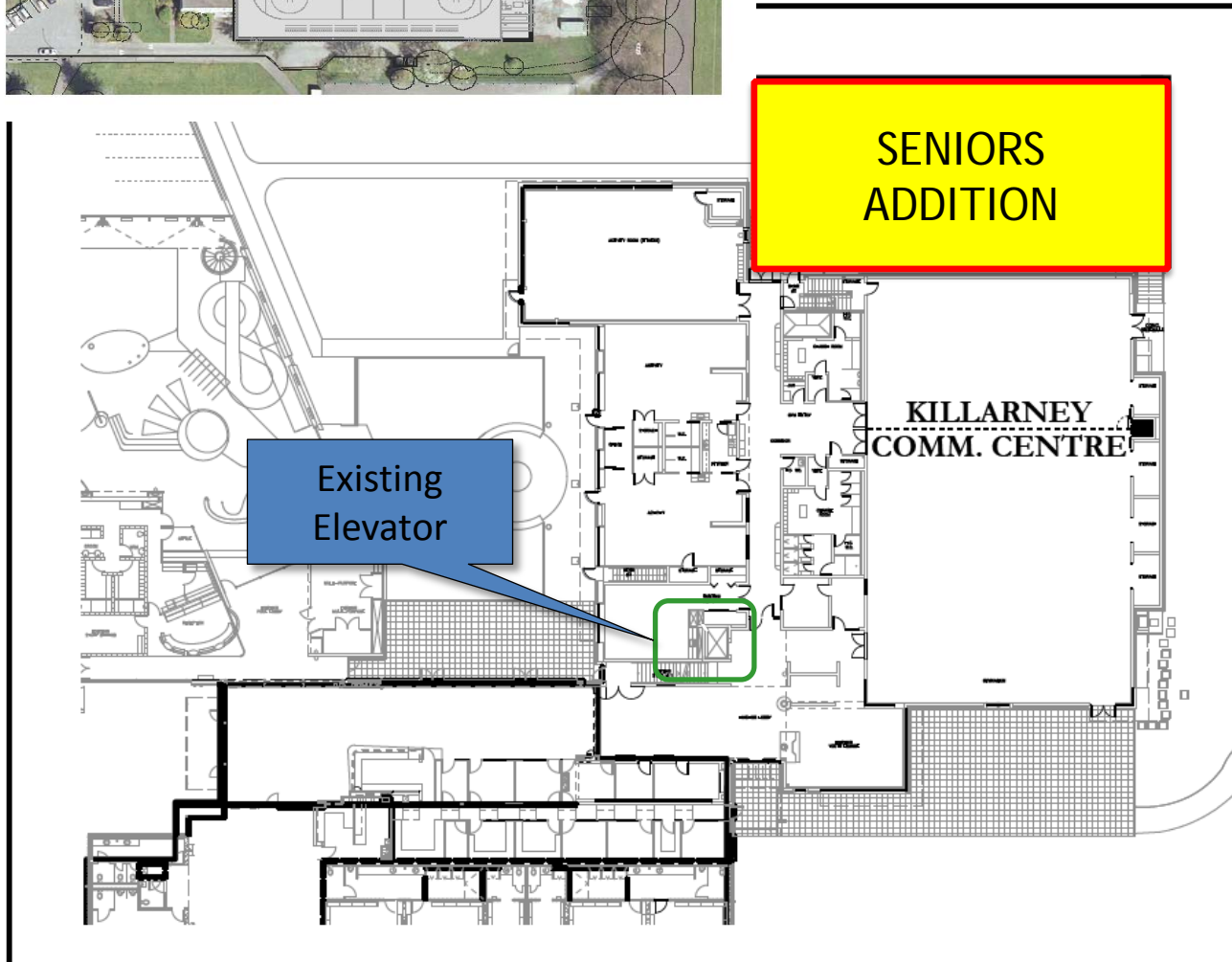

Lower Floor Plan

Killarney Seniors Centre CONSULTATION PROCESS

- Sept. 2014 - Bridging consultant team hired
- Nov. 2014 – programming meetings held with the Killarney Seniors Centre Building Committee and numerous community stakeholder groups
- Early 2015 - design meetings held with the Building Committee
- March 2015 – Building Committee endorses preferred option

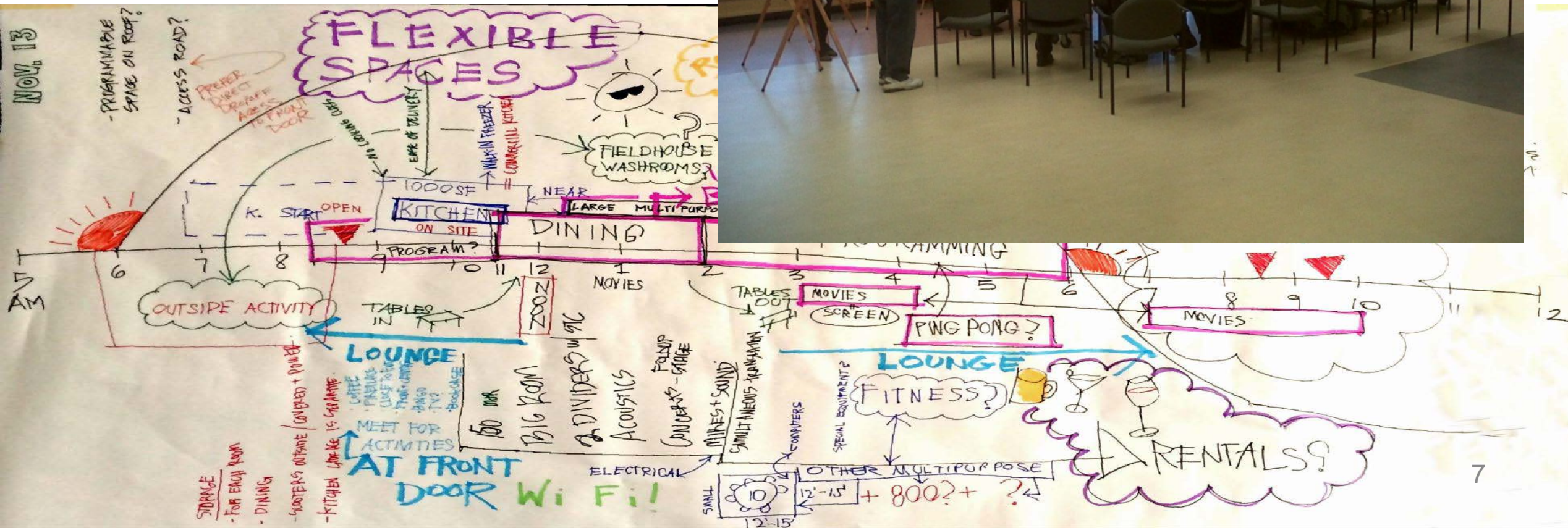

Killarney Seniors Centre

INDICATIVE DESIGN - LOWER FLOOR PLAN

The lower floor includes:

- a reception and office area
- multi-purpose rooms
- commercial kitchen
- washrooms
- storage
- corridor and staircase
- two field washrooms

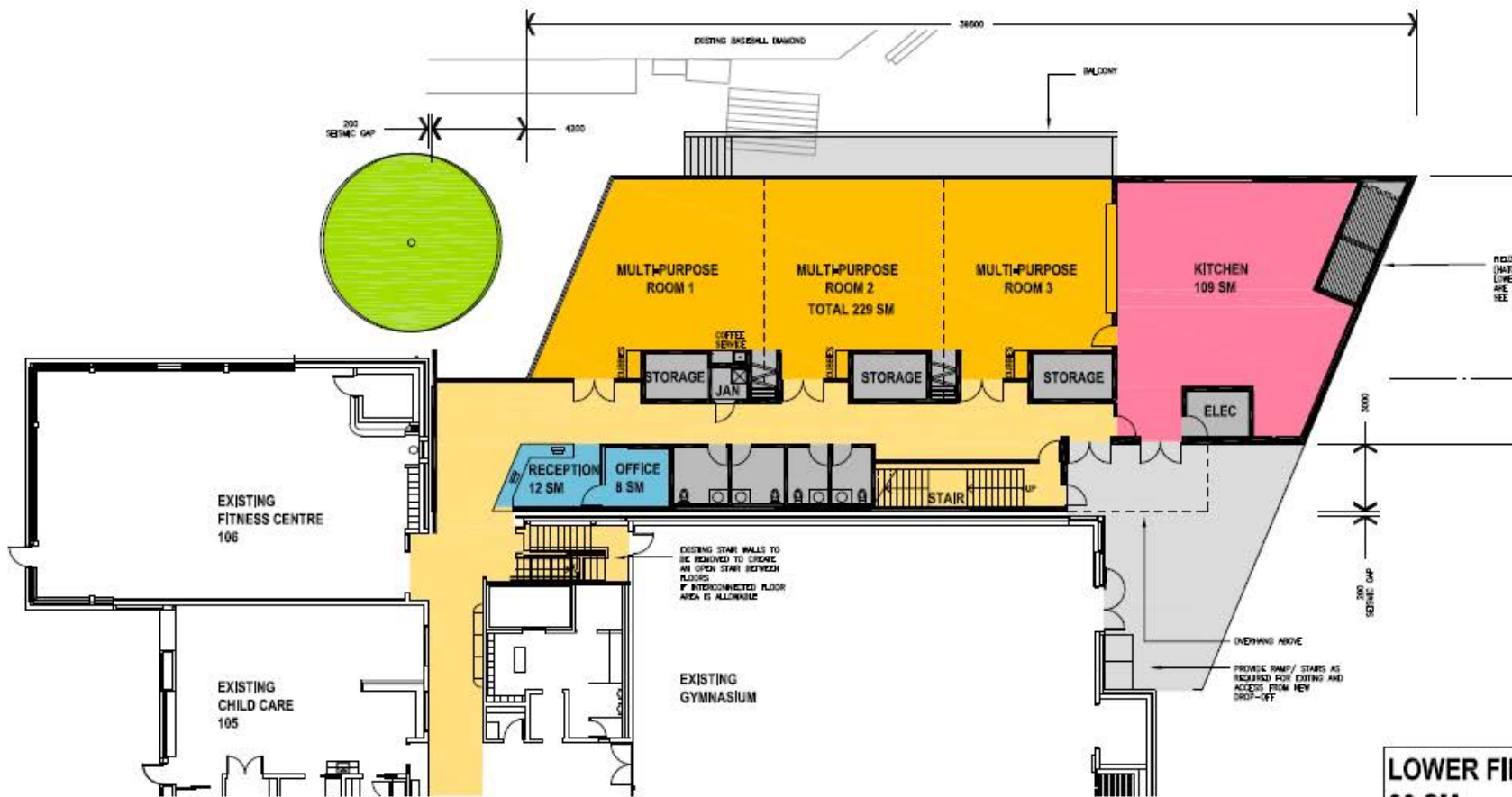

MAIN FLOOR
528 SM

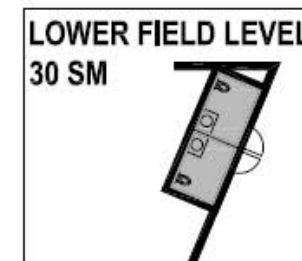

INDICATIVE
DESIGN
MAIN FLOOR PLAN

Sheet
1439
Date
19-07-2014
Scale
1:100

5

These drawings are for informational purposes only and do not constitute a contract. The City of Vancouver is not responsible for any errors or omissions in these drawings and does not warrant the accuracy or completeness of the information provided.

Killarney Seniors Centre

INDICATIVE DESIGN – UPPER FLOOR PLAN

The upper floor includes:

- multi-purpose rooms
- lounge
- meeting room
- storage
- washrooms
- corridor and staircase
- roof deck
- renovated kitchen in existing centre



SECOND FLOOR
388 SM (EXCLUDING ROOFTOP)

Killarney Seniors Centre

KCC – EXISTING ELEVATOR

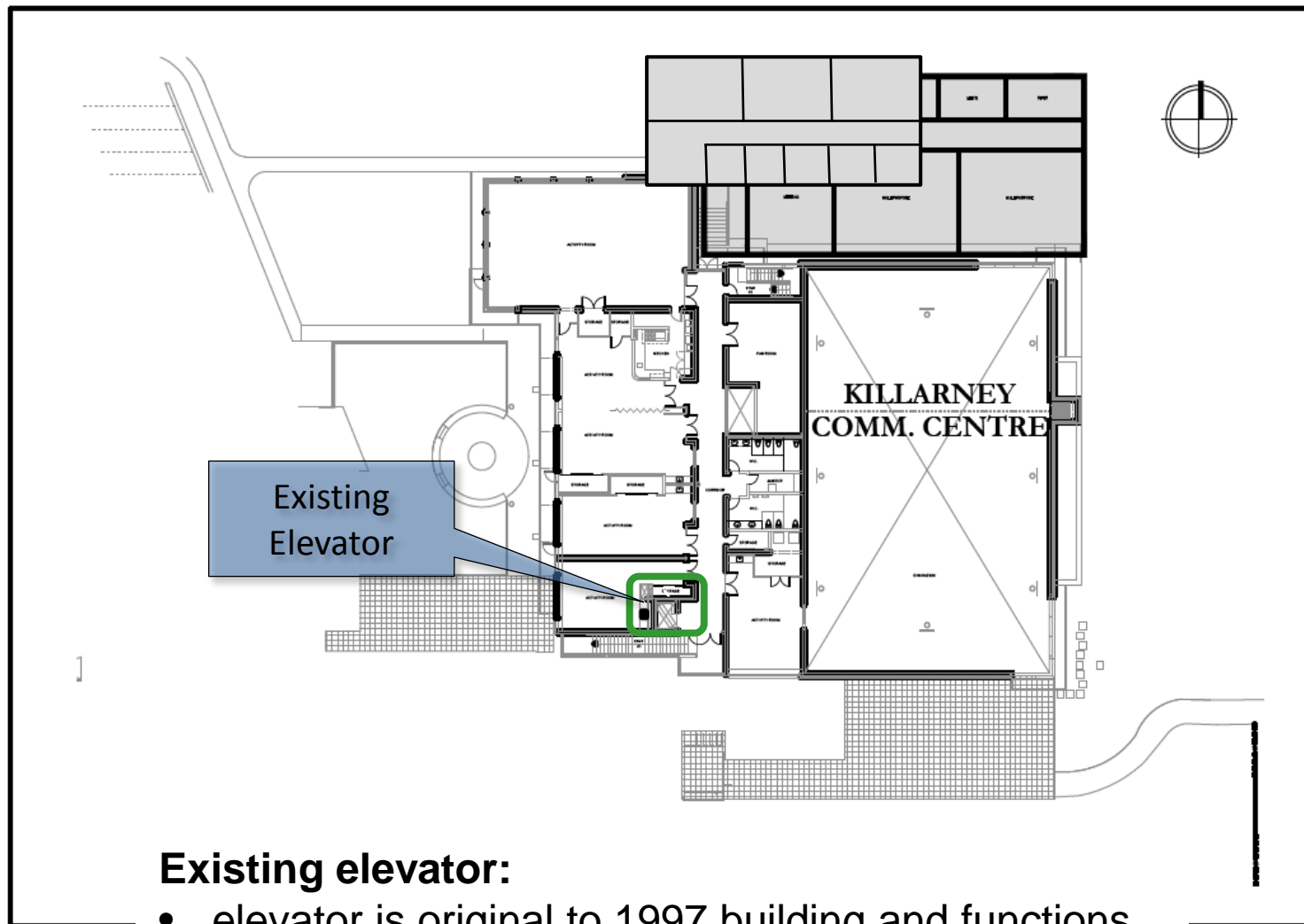

Existing elevator:

- elevator is original to 1997 building and functions well
- elevator study concludes that one elevator is sufficient for occupant load of the expanded community centre

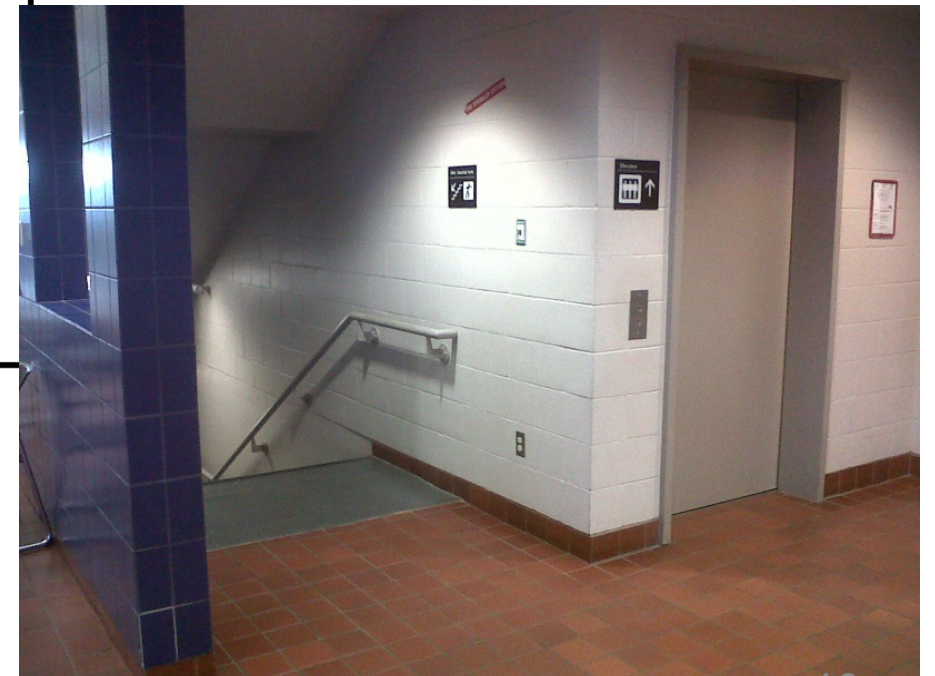

Killarney Seniors Centre

PROCUREMENT PROCESS

- Request For Qualifications for Design-Builder PS20150098 issued Feb. 2015
 - Six submissions received
 - Three teams shortlisted including:
 - Ventana Construction Corporation and Taylor Kurtz Architecture + Design
 - DGS Construction Company Ltd. and SHAPE Architecture Inc.
 - Kindred Construction Ltd. and DYS Architecture
- Request for Proposals for Design Builder PS20150238 issued Oct. 2015
- All 3 shortlisted teams submitted proposals. Based on the overall evaluation criteria the proposal submitted by the partnership of Ventana Construction Corporation and Taylor Kurtz Architecture + Design, best met the requirements and provided best overall value based on technical and commercial evaluation
- Bid Committee approved the proposal to enter into a contract with the Ventana/Taylor Kurtz team on Jan. 22 2016
- Report to Park Board for approval on Feb. 22 2016
- Report to Council for final approval on Feb. 23/24 2016

Killarney Seniors Centre

PROCUREMENT PROCESS

Proposals evaluated on:

Technical requirements:

- Material Non-Compliances
- Satisfied the provisions of the RFP
- Demonstrated understanding of the project and work and capability to perform and deliver the project

Commercial requirements:

- Nominal cost not to exceed ceiling price \$5.9 million
- Number of scope reductions to bring cost below ceiling price
- Number of proposed scope increases included in the nominal cost that is below the ceiling price

Killarney Seniors Centre PROPONENT DESIGN



Interior View Looking West



Interior View Looking East



North West View

ventana
ventana
construction
corporation

TKA+D



Killarney Seniors Centre

SUSTAINABILITY FEATURES

The project will achieve LEED Gold certification with a 35% reduction in energy consumption over Vancouver Building Bylaw requirements, and will include the following features:

- Enhanced building envelope
- Operable windows
- LED lighting
- Water efficient plumbing fixtures
- Heat recovery and on-demand control
- Non-mechanical cooling
- Passive natural ventilation
- Rooftop rain water retention
- Light coloured roof to reduce heat island effect
- Specification of environmentally friendly materials and products focussed on durability



Killarney Seniors Centre

DESIGN-BUILDER'S PROJECT SCHEDULE

February 2016	Design-Build contract in place
June 2016	Development Permit submission
September 2016	Building Permit submission
January 2017	Construction start
February/March 2018	Construction completion
March 31 2018	Federal & Provincial deadline for completion

Killarney Seniors Centre

Thank you / Questions